

Scratch Ticket Dispenser

Instant Lottery Ticket Dispenser ccTalk Interface

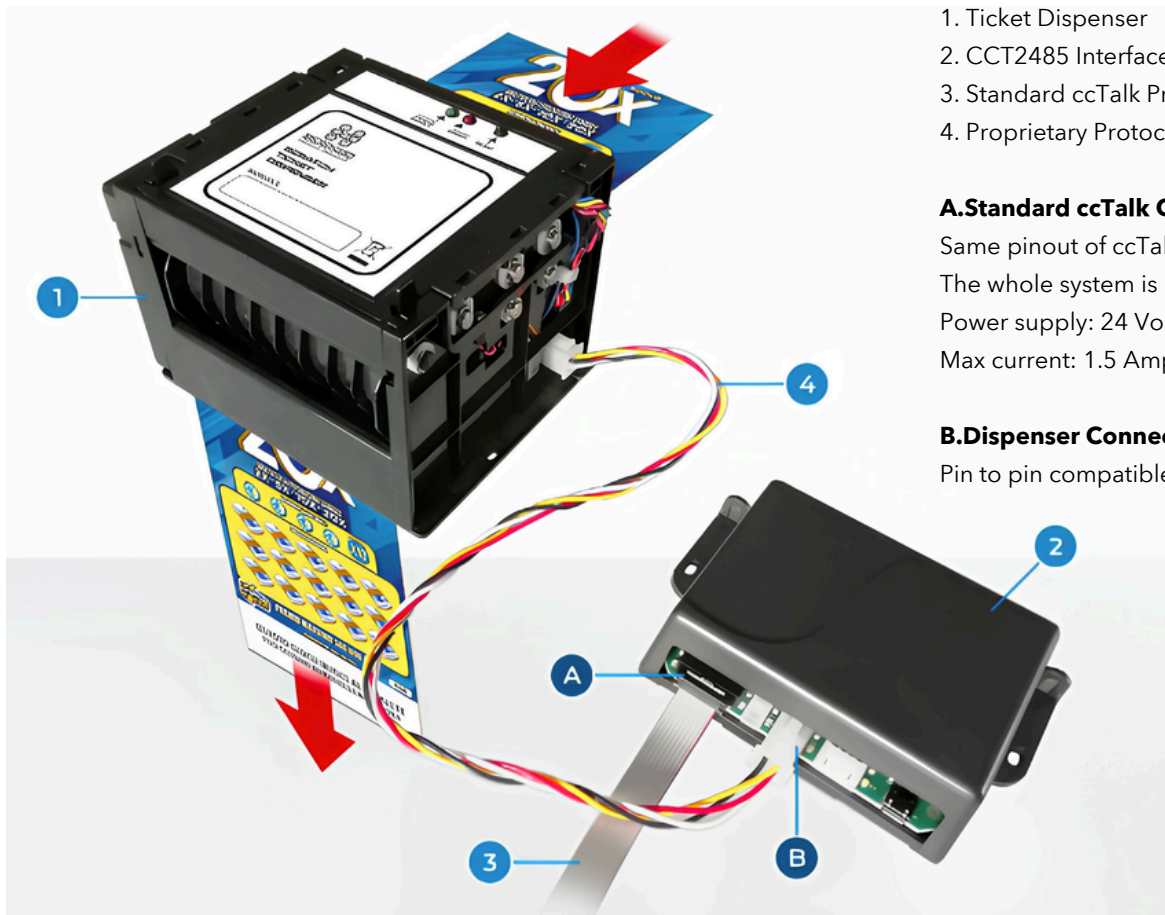

1. Ticket Dispenser
2. CCT2485 Interface Board
3. Standard ccTalk Protocol
4. Proprietary Protocol

A. Standard ccTalk Connector

Same pinout of ccTalk Hopper.

The whole system is powered by this connector.

Power supply: 24 Volt DC (+/- 10%)

Max current: 1.5 Amp.

B. Dispenser Connector

Pin to pin compatible dispenser connector



NO OTHER CONNECTIONS REQUIRED!



Technical Specifications



To properly dispense the perforated lottery ticket, the exact ticket length must be set in the dispenser. You can predefine the exact length (mm) of the ticket and regulate the frequency of ticket cuts.

The dispenser has four length parameters in its NVRAM (from 1 to 4). Each parameter holds one length in mm. This length can vary from 10 to 300 mm.

Only one parameter length at a time is selected and active. This selection is held in NVRAM. The ccTalk HEADER 255 is used to read and set these parameters.

Dimensional Drawings

