

# "Quick Release" Ticket Dispenser Manual

U.S. Patent 5833104  
Additional Patents Pending

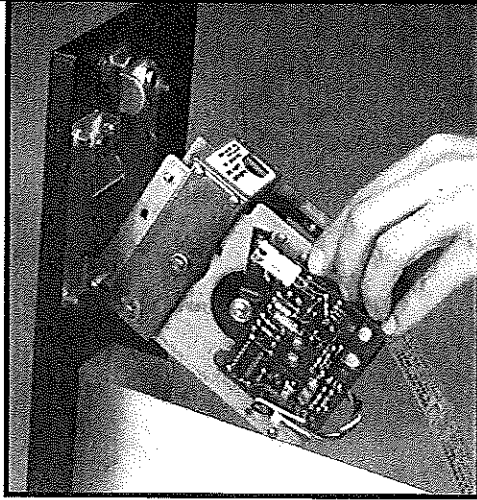

42-0544-00

42-0547-00

## The "Quick Release" Ticket Dispenser

- Quick release face plate
- Bottom metal ticket guide
- Foolproof braking system
- Optical sensor dust cover

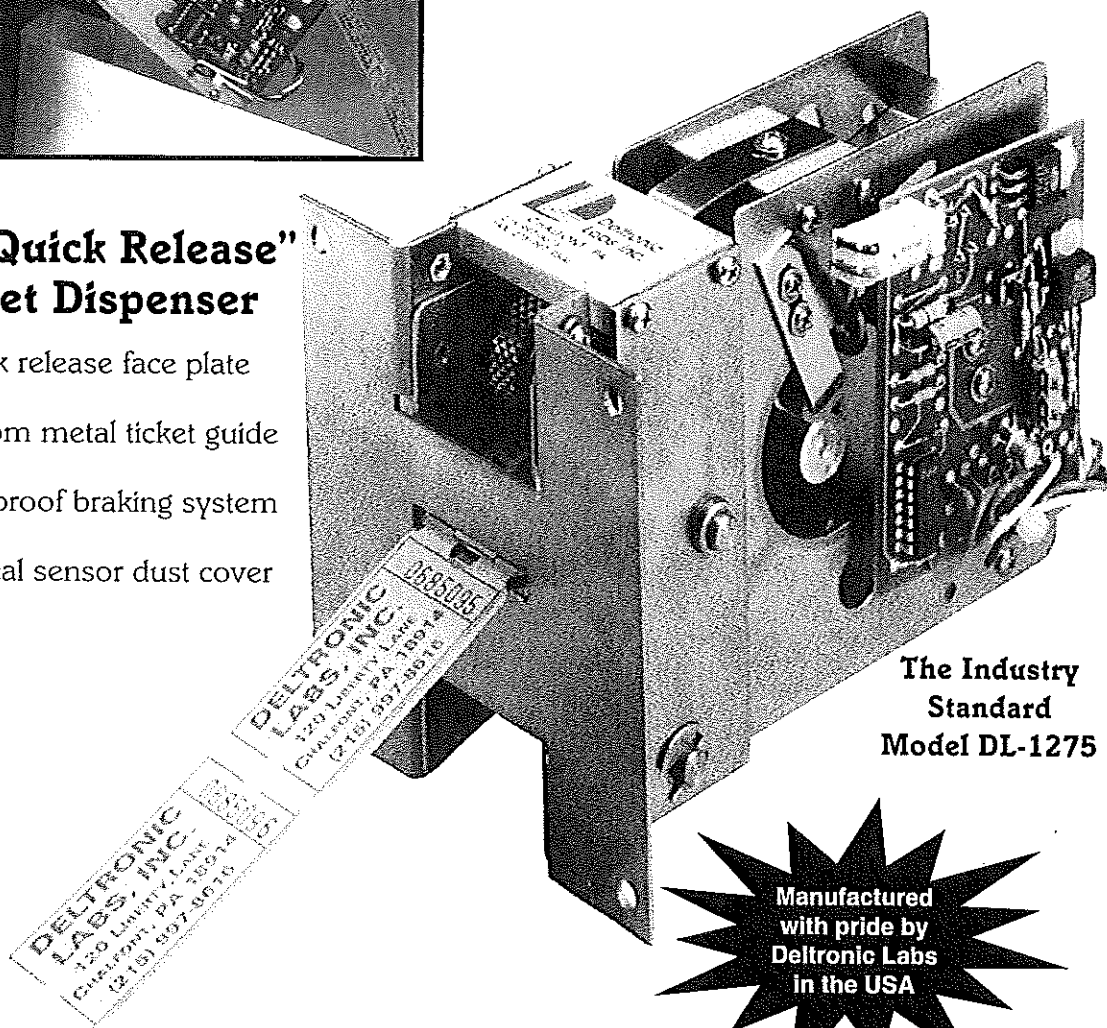

The Industry  
Standard  
Model DL-1275

Manufactured  
with pride by  
Deltronic Labs  
in the USA

Another quality product from Deltronic Labs . . .  
the industry leader in ticket dispensers.



**Deltronic Labs, Inc.** 120 Liberty Lane, Chalfont, PA 18914  
215-997-8616 • FAX# 215-997-9506 • Web Site: [www.deltroniclabs.com](http://www.deltroniclabs.com)

# "Quick Release" Ticket Dispenser

## Features All Models

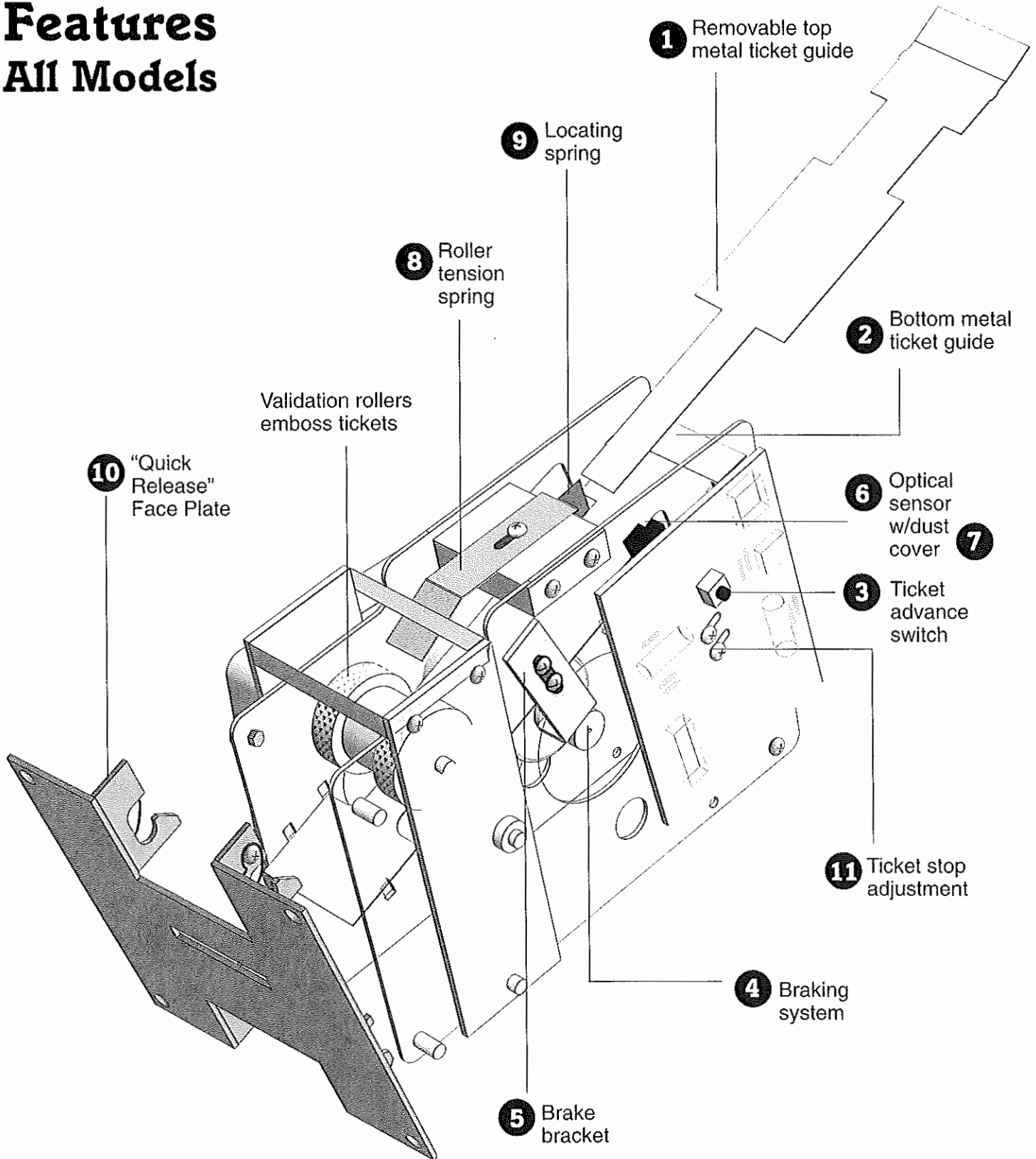

- 1 Top Metal Ticket Guide**  
For servicing, the top metal ticket guide can be removed and replaced. With unit facing you, gently spread side plates with thumb and index finger. Tilt guide to right at 45° angle and snap left side tab out and pull straight back. When replacing, simply reverse these steps. Note there is no need to spread side plates while replacing guide. Tilt to right and insert right tab first.  
Note: When PCB has opto-sensor cover, guide is inserted over sensor then directed down to right. Be sure guide is **BELOW** brake bracket screws when replaced.
- 2 Bottom Metal Ticket Guide**  
The longer, more durable ticket guide extends through the face plate allowing for better guidance plus a larger opening in the face plate prevents curled tickets from catching.
- 3 Loading of tickets with ticket advance switch**  
Tickets are inserted in the rear of machine between the top and bottom ticket guides and pushed forward to the rollers. If needed, gently push the locating spring (9) away from the ticket guides. Then push the ticket advance switch until you see the edge of first ticket.
- 4 Braking system**  
Our impressive new braking system eliminates brake slippage allowing foolproof, accurate dispensing. The new design also reduces wear and tear on the dispenser.
- 5 Brake bracket**  
The brake is easily accessible and can be adjusted to engage immediately when ticket is pulled. (Minimum of 1/8" from brake wheel.)
- 6 Opto-Sensor**  
Included as part of the controller is an opto-electronic beam sensor which detects the notch between tickets. The output of the ticket sensing circuitry is an open collector transistor.
- 7 Opto-Sensor Dust Cover**  
In addition, an optical sensor dust cover is also included to eliminate the possibility of ticket dust accumulating on the optical sensor. This increases the accuracy of the ticket count and reduces maintenance.
- 8 Roller Tension Spring**  
The roller tension springs keep constant tension on tickets which insures proper delivery and prevents the tickets from being "pulled through" when the dispenser is idle. To increase the tension, loosen the screw and move the spring forward. Tension is correctly adjusted when tickets cannot be pulled from the dispenser and validation rollers lightly emboss the tickets.
- 9 Locating Spring**  
The ticket guide spring insures that the notches in the tickets pass through the opto-sensor. To decrease tension, loosen the screw and move the outer tension spring up. This changes the tension on the inner spring. The tickets should be snug between the spring and the side plate but not deformed by the excess tension. The spring is adjusted at the factory for 1-5/32" wide tickets and positioned 1/8" from ticket guides.
- 10 "Quick Release" Face Plate**  
The dynamic new design allows the ticket dispenser to "quickly release" from its face plate on your cabinet or ticket door. This can be done manually and no tools are needed. This gives you complete access to the front of the rollers and to the ticket guides. Plus you can "snap out" one ticket dispenser and immediately replace it with another in just seconds.
- 11 Ticket Stop Adjustment**  
The ticket stop adjustment allows you to position the tickets while the machine is off. The tickets should protrude through the slot at least 1/16". The ticket dispenser PC board is mounted on spacer with two screws with washers in two slotted holes. Loosening the screws and moving the board forward will allow the tickets to stop further out beyond the edge of the slot.

## Dispenser Specifications

The quick release face plate greatly improves serviceability and reduces maintenance. Now standard on all Deltronic Labs Ticket Dispensers.

- Low voltage operations, only 12V DC
- Solid state output allows interfacing with electronic games
- Compact size, only 3-1/8" W x 4" H x 5-1/2" L
- Weight: 2-1/4 lbs.
- Validation "diamond" mark identifies tickets that have been dispensed.
- Adjustable ticket stop
- Dispenses 2"L x 1-5/32"W tickets
- 4"L x 2"W ticket
- 4"L x 1-5/32"W ticket
- 2"L x 2"W duplex ticket
- One year warranty
- Standard face plate: 4"H x 3-3/4"W
- Narrow face plate: 4"H x 3-1/8"W
- 12V meter output
- CE (when requested)

# Control Board Rev. 8

## DL-1275 with 12V meter output

This dispenser is controlled by the game software. The game turns on the dispenser with a logic high signal and monitors a return notch signal from the ticket dispenser to turn it off. It will dispense as many tickets as games options allow.

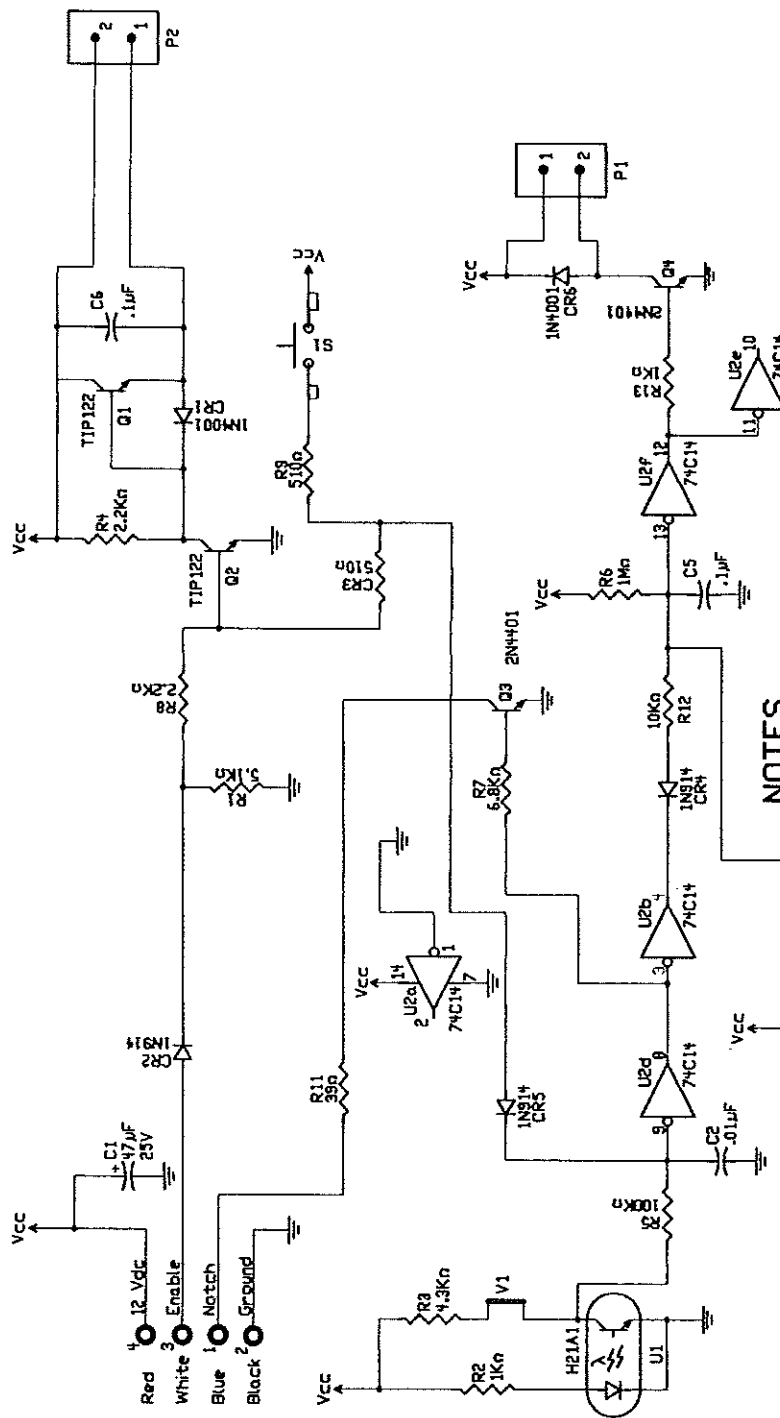

### NOTES

- Resistor R9 and diode CR3 and the jumper going to pin 1 of the IC are changed for this revision. This was done to limit the current going thru the switch and then to pins 1 & 3 of the IC. This resolves problems that occurred with units that used unregulated power supplies. Deltronic Labs still recommends that regulated supplies be used. Changes closely reflecting these changes were made in the previous revision (Rev. 7).
- Resistors R10, R15, and R25 were deleted from this schematic. The Rev. 7 schematic shows these resistors, but they were never actually inserted on the board.
- The unit as shipped from the factory (as per this schematic), will trigger the counter whenever tickets are dispensed normally, but NOT when doing so by pressing the switch. If desired, the unit can be changed so that tickets dispensed by pressing the switch are also counted. Do this by deleting diode CR5.
- This unit can be made to conform to CE specifications by the addition of 4 components not shown here. If this is desired, please order the CE version, and the unit will be shipped with the necessary components.
- This unit can be configured in a number of ways. Please check our "Full Options" schematic to see the different configurations. If this schematic is not included with your manual, contact us for a copy.
- If tickets are highly translucent, the 4.3Kohm resistor (R3) can be lowered in value (e.g. 2.2 Kohm). For more sensitive adjustment, the jumper V1 can be replaced with a 25K pot, and the 4.3 Kohm resistor (R3) changed to 1Kohm.

MIN.	TYP.	MAX.
11 V	12 V	13 V
1.3 A	1.5 A	1.7 A
---	.4A	.85 A
---	30 MA	---
2.5 V	---	12 V
250 µA	---	2.5 MA
---	---	1.0 V
---	---	0 MA
---	---	50 MA
---	---	30 V

MOTOR SUPPLY - V --  
 I (START) ---  
 I (RUN) ---  
 I (STANDBY) --  
 MOTOR ENABLE ON - V --  
 MOTOR ENABLE OFF - V --  
 TICKET NOTCH - I SINK --  
 V PULL UP --

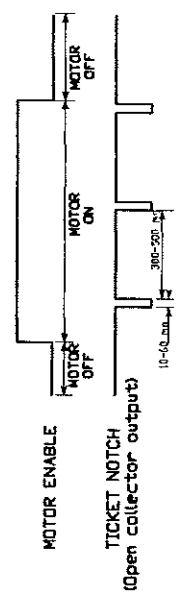

# Control Board

## Models DL-4-S-S DL-4-P-S

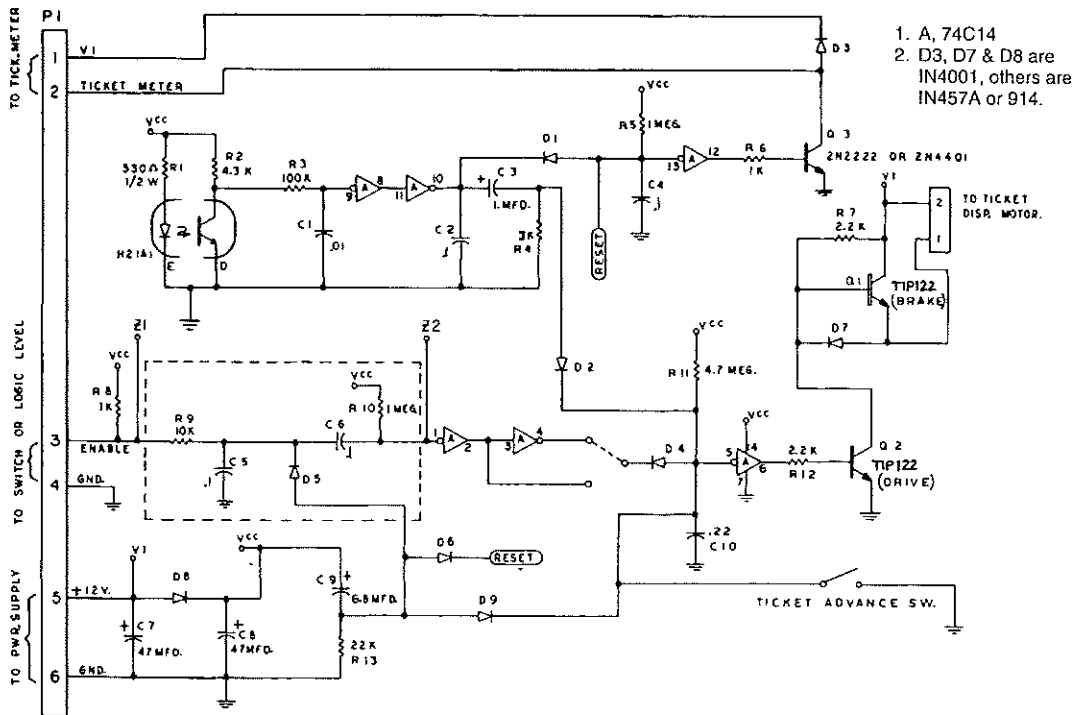

1. A, 74C14
2. D3, D7 & D8 are IN4001, others are IN457A or 914.

Model #DL-4-S-S, SW Input  
 Model #DL-4-P-S, Logic Input.

Note: With logic input components and dotted lines are omitted and Z1 is jumpered to Z2.

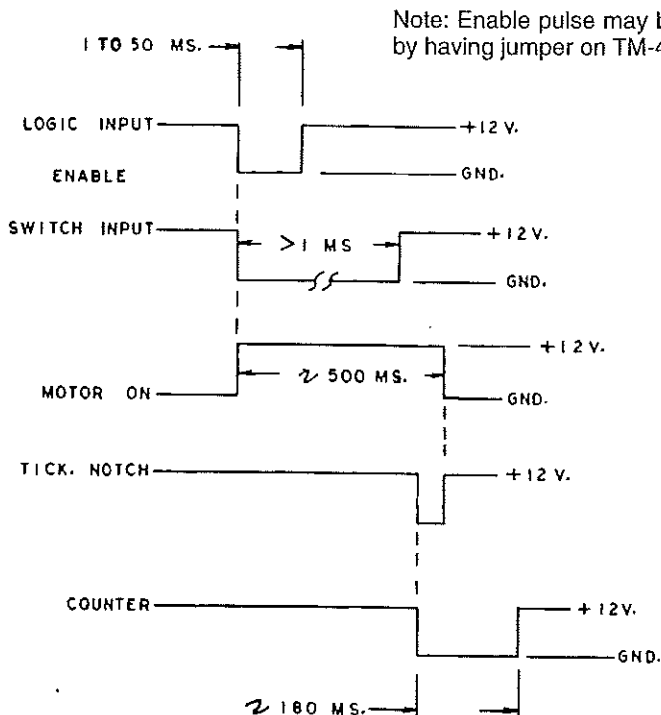

Note: Enable pulse may be positive or negative by having jumper on TM-4 in proper place.

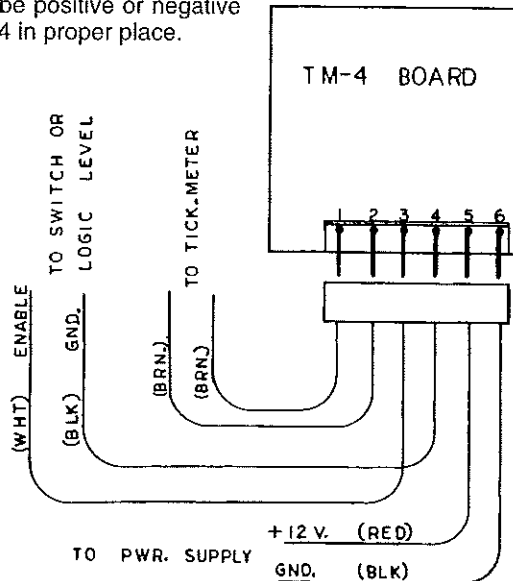

Note: On PCB TM-4, Rev. 1 & 2, Q1 and Q2 transistors are D40K1 or equivalent.

Model #DL-4-S-S  
 Model #DL-4-P-S

# Ticket Dispenser Assembly

Details of Parts			
F/N	Qty	Deltronic Labs P/N	Name
11	1	SHFT-IDLRLR/TD/	IDL ROLLER SHAFT
12	1	RM-SFTMTR/TD/	MOTOR PIVOT SHAFT
13	1	SPAC-PIVBLK/TD/4HOL	PIVOT BRACKET SPAC
14	1	RM-SPCPB/TD/	SPACER BLOCK
15	2	RM-RLRIOL/TD/VALD	IDLER ROLLER
16	1	RM-RLRDRV/TD/VALD	DRIVE ROLLER
17	2	SPRG-TENSN/TD/	TENSION SPRING
18	2	RM-BKTPVT/TD	MTR PIVOT BKT.
19	1	RM-PANLFT/TD.NOPM	FRONT PANEL
20	1	RM-VHLBRK/TD/	BRAKE WHEEL
21	1	SPRG-LOCAT/TD/	LOCATING SPRING
22	1	RM-BKTBRK/TD/	BRAKE BRACKET
23	1	RM-BKTTUB/TD/3/8	URETHANE BRAKE
24	1	PCBD-1275/TD/ *	PC BOARD
25	1	RM-MOTOR/TD/	MOTOR
26	2	RM-PLATFR/TD	FRAME PLATE
27	1	RM-CONN2P/TE20G	2-PIN FEMALE CONN
28	4	BRNG-F312/TT/BRASS	BUSHING
29	1	SPAC-PCBD/TD/	P.C. BOARD SPACER
30	1	SPAC-HEX/TD/1-1/4	HEX SPACER 1-1/4"
31	1	RM-.1M/TT/50V	.1MFD 50V
32	1	SPAC-HEX/TD/1/4"	STAND OFF
33	1	GUID-BOTTOM/TD.MET	LOWER GUIDE MET.
34	4	RING-E2SRT/TT/	RETAINING RING
35	1	GUID-TOP/TD.MET	TOP GUIDE METAL
36	2	PULY-SP212/TE/NYLN **	SPACER WASHER
37	2	SPRG FRONT/TD/	SPRING FRONT-PLATE
38	4	RM-PEMNUT/TD.FRPL	PEMNUT FRAME
39	2	RM-PEMNUT/TD.FRPN	PEMNUT FRONT
40	1	COVR-H21A/TD.OPTO	DUST COVER
41	1	CONN MOLEX/TD/4PM	4 WIRE MOLEX MA.
42	1	RM-LABEL/TD/ALUM.	LABEL ALUMINUM
43		WIRE-REDBLK/TD.MOTOR	
44	2	SPAC-PIWBRK/TD.HEX***	SPACER 1/4" HEX.

\* Order by Model #

\*\* Note: F/N #36 replaces .032 and .093 spacer washers.

\*\*\* Note: F/N #44 replaces large spacer block.

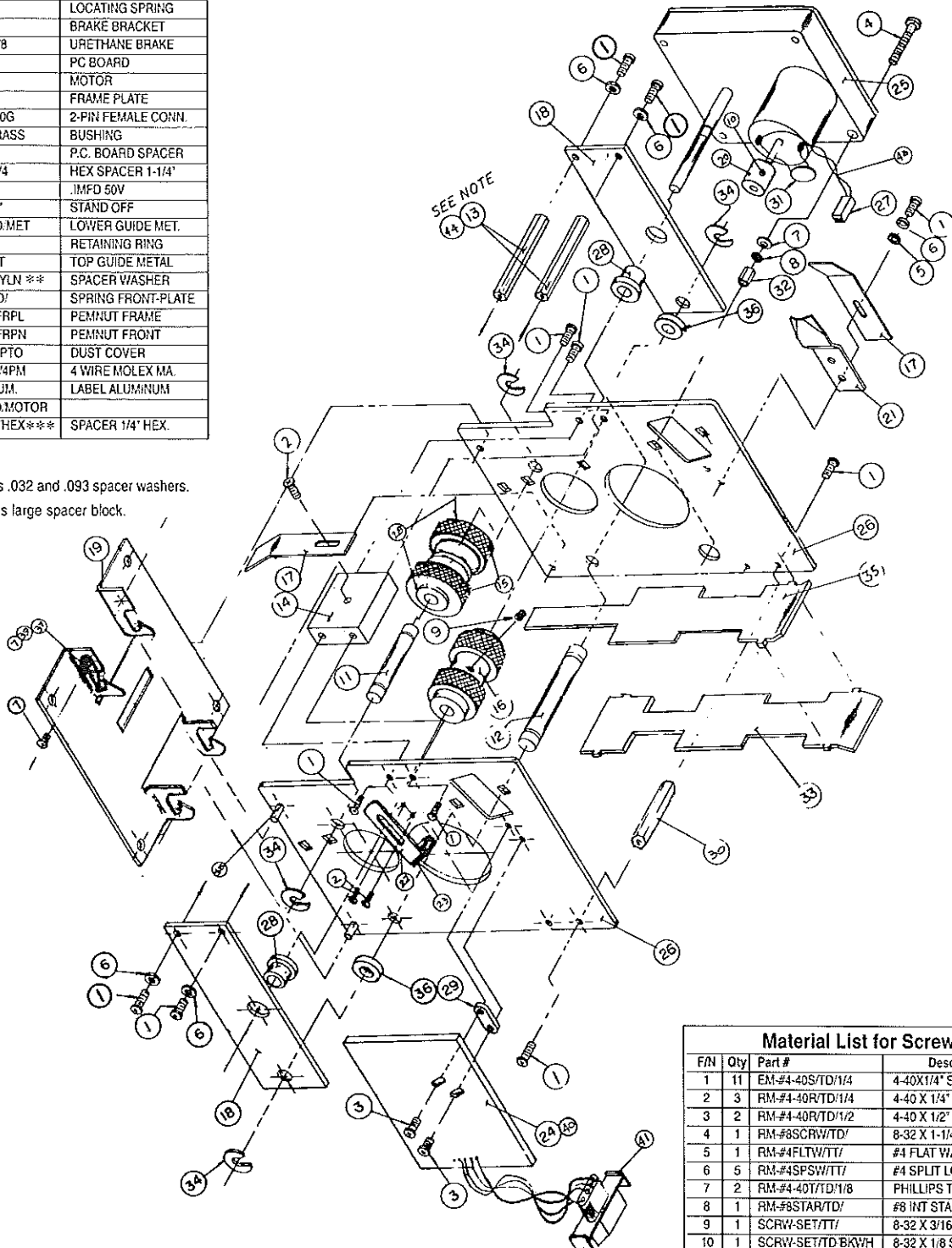

## Material List for Screws

F/N	Qty	Part #	Description
1	11	EM-#4-40S/TD/1/4	4-40X1/4" SCREW
2	3	RM-#4-40R/TD/1/4	4-40 X 1/4" WASHER HEAD
3	2	RM-#4-40R/TD/1/2	4-40 X 1/2" WASHER HEAD
4	1	RM-#8SCRW/TD/	8-32 X 1-1/4"
5	1	RM-#4FLTW/TT/	#4 FLAT WASHER
6	5	RM-#4SPSW/TT/	#4 SPLIT LOC. WASHER
7	2	RM-#4-40T/TD/1/8	PHILLIPS TRUSSHEAD
8	1	RM-#8STAR/TD/	#8 INT STAR WASHER
9	1	SCRW-SET/TT/	8-32 X 3/16" SET SCREW
10	1	SCRW-SET/TD BKWH	8-32 X 1/8 SET SCREW

# Service

# Interface Solutions

## Technical Support

Questions? Problems? Please call our Service Department at 215-997-8616 or go to [www.deltroniclabs.com](http://www.deltroniclabs.com) and we'll do our best to get you up and running.

## 24-hour repair available

Upon customer request, all warranty and non-warranty items returned to Deltronic Labs can be serviced and shipped back to the customer the same day they arrive. Be sure to include your shipping requirements and return address.

## Fast parts service

We provide quick shipping from our manufacturing inventory.

## Fast repair service

Most repairs are done within 24 hours.

## On time delivery

Our reputation is second to none.

## Warranty Information

Deltronic Labs offers the following one year warranty on all ticket dispenser models from the date of purchase:

### One Year Warranty

Deltronic Labs will replace or repair any mechanical or electronic parts damaged as a result of component or circuit failure. We will also repair or replace defects in parts or assembly caused by normal operations.

Deltronic Labs will not, however, be responsible for damage caused by or due to misuse of operation or power requirements, including system overloads or modification and burn out of electronic boards. Nor will Deltronic Labs be responsible for visible damage or broken or missing parts caused by tampering with the units or unauthorized servicing.

## Yogi II

- Operator adjustable
- Jackpot prevention
- Drop or return pulse
- Ticket return memory

## Adjuster

- Converts any game to DL-1275
- Program custom payouts
- Power diversion feature
- Mercy ticket at coin op

## NC-100 No Cheat

- Eliminates jackpotting
- Eliminates theft
- Power diversion feature
- Simple & cost effective

## Slot 500

- Dispense – coins in – coins bet
- On board programming
- Time out – reset option
- Interface with player tracking card

## U-Set It Printer Interface

- Dispense receipt option
- On board programming
- Multiply or divide pulses
- Generate audit report

## TD Bench Tester

- Test any DL TD on local
- Portable
- Troubleshooting guide
- Saves time & money

## RS232 TD Controller

- Control from 1 to 8 Dispensers
- Serial port connection
- Five simple commands
- Ticket Audit Report

**\* Custom Programming \***  
available

Please call for additional information and prices.

# Parts and Accessories

## One Pulse Ticket Dispenser

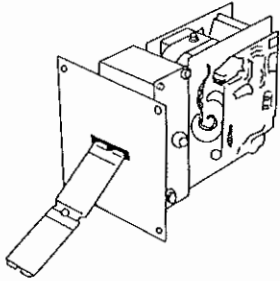

### The DL-4-S-S (SW) input

This is a one pulse-one ticket dispenser. The game pulses the dispenser once and one ticket is vended.

#### Logic Input Option:

The DL-4-P-S uses a logic input rather than a switch to pulse.

#### Optical Coupler Option:

The DL-4-O-S uses an optical coupler input instead of a switch or logic to pulse.

Note: DL-4-S-S and P-S dispensers have 12V ticket meter output.

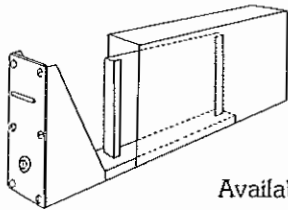

An **outside mount aluminum housing** for ticket dispenser and ticket bin, mounts on the outside of a cabinet. Ticket dispenser slides in, locks with key.

Available with Low Ticket Indicator Light

18"L x 4"W x 7"H

For use with

- Pinballs
- Videos
- Slots
- Countertop videos
- Admissions



### Mounting Plate

A stainless steel plate that mounts to the front of our ticket dispenser and allows for direct mounting to your cabinet (comes with hardware).

5"L x 5"W

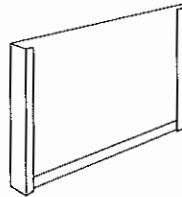

### Ticket Bin

DIMS - 2500 capacity  
10-3/4"L x 1-1/2"W x 6"H

4000 capacity  
10-3/4"L x 1-1/2"W x 12"H

## Admission Keypad Ticket System – Pedestal and Portable

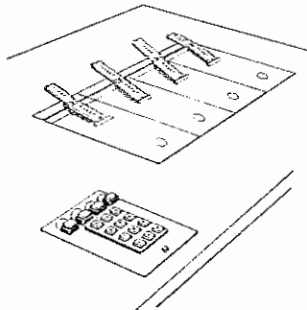

- Free your people from fumbling with stacks of tickets and cash
- Great for admissions at ticket booths and amusement parks
- Use from 1 to 7 dispensers.
- Allows for multiple values and multiple ticket colors to be dispensed at one station.
- Individual meter readings
- Free your personnel from handling several stacks of different tickets and cash at the same time.
- Deltronic's new modular admission keypad ticket systems control multiple ticket dispensers from one keypad. Just enter any number of tickets from 1 to 99.
- Error alarm
- Dispenses 2" x 1 5/32" & 2" x 4" Tickets.
- RS-232 Interface

## The Ticket Eater® counts, destroys, and tracks redemption tickets, faster, easier & more accurately than ever before.

### DL-5000

Our standard Ticket Eater® unit with hard mounted 4-digit display

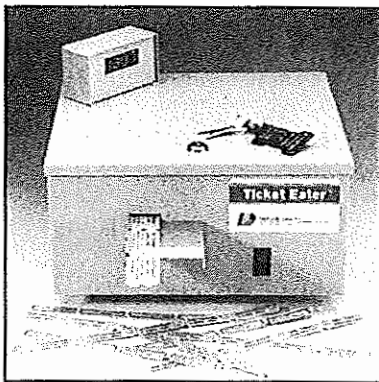

### DL-6000

The Ticket Eater® with additional large, 3-digit movable display (shown below with optional stand)

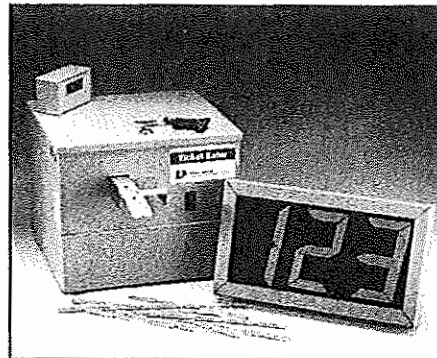

### DL-9000

Micro-processor controlled Ticket Eater® System with mid-sized, movable display, receipt printer and programmable keypad (shown below with optional stand)

