

Rev	AMEND	DATE	CHECK	APPR.
P1	Proto	2017.12.08	H.I.Woo	H.Y.Sohn
P2	Changed Model Name INC-2703FHRNPC-U ---> 150LP2700	2018.01.03	H.I.Woo	H.Y.Sohn
P3	Changed Main Frame Size H : 663 --> 660mm / V : 410 --> 407mm	2018.02.05	H.I.Woo	H.Y.Sohn
P4	Changed Frame Total thickness 57.3mm --> 51.0mm	2018.05.10	H.I.Woo	H.Y.Sohn
P5	Changed I/O Port Name RGB Input ---> VGA Input	2019.05.28	H.I.Woo	H.Y.Sohn

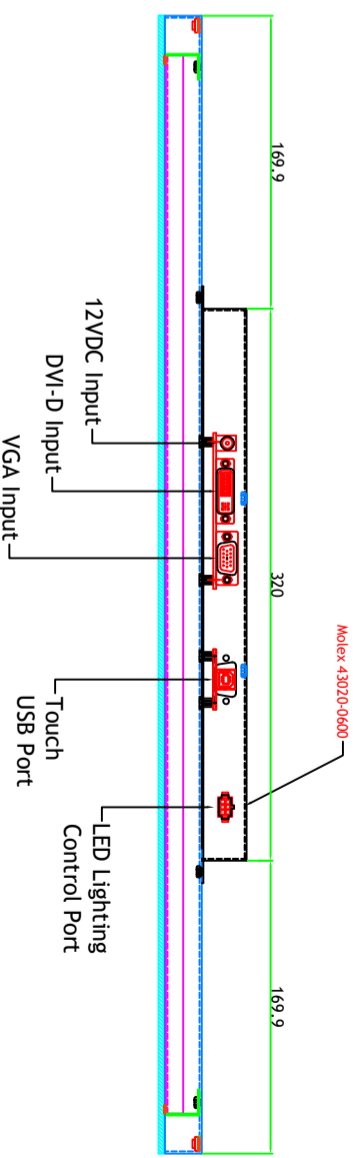
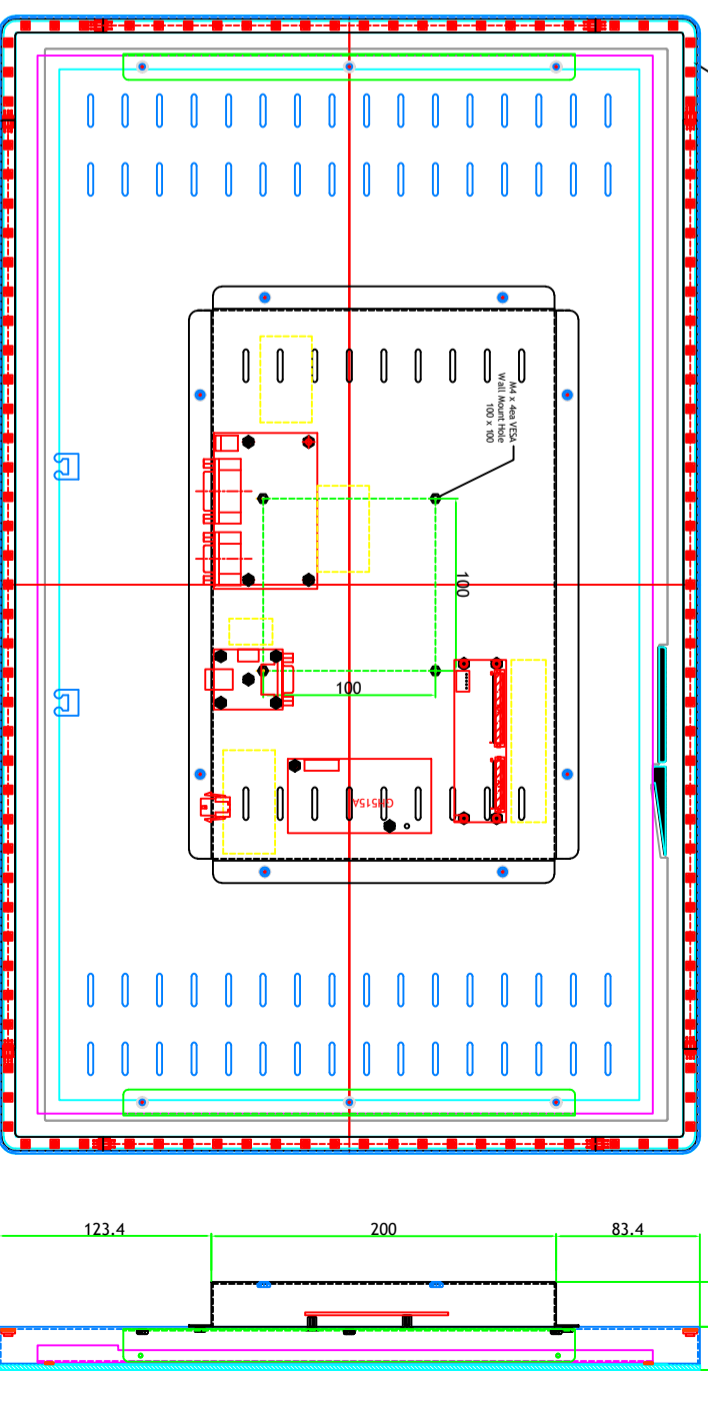
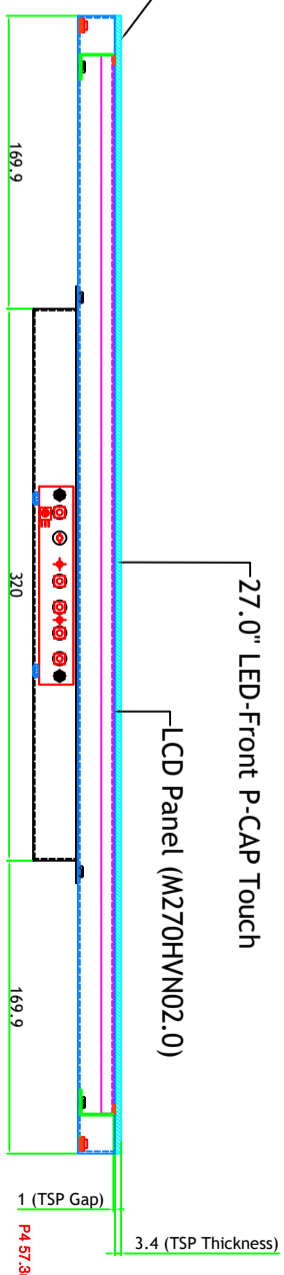
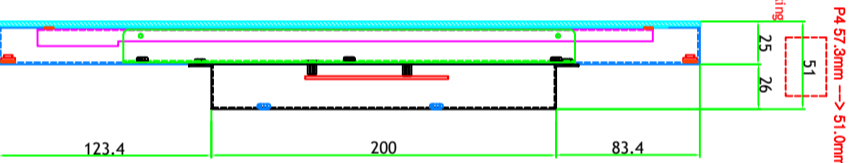
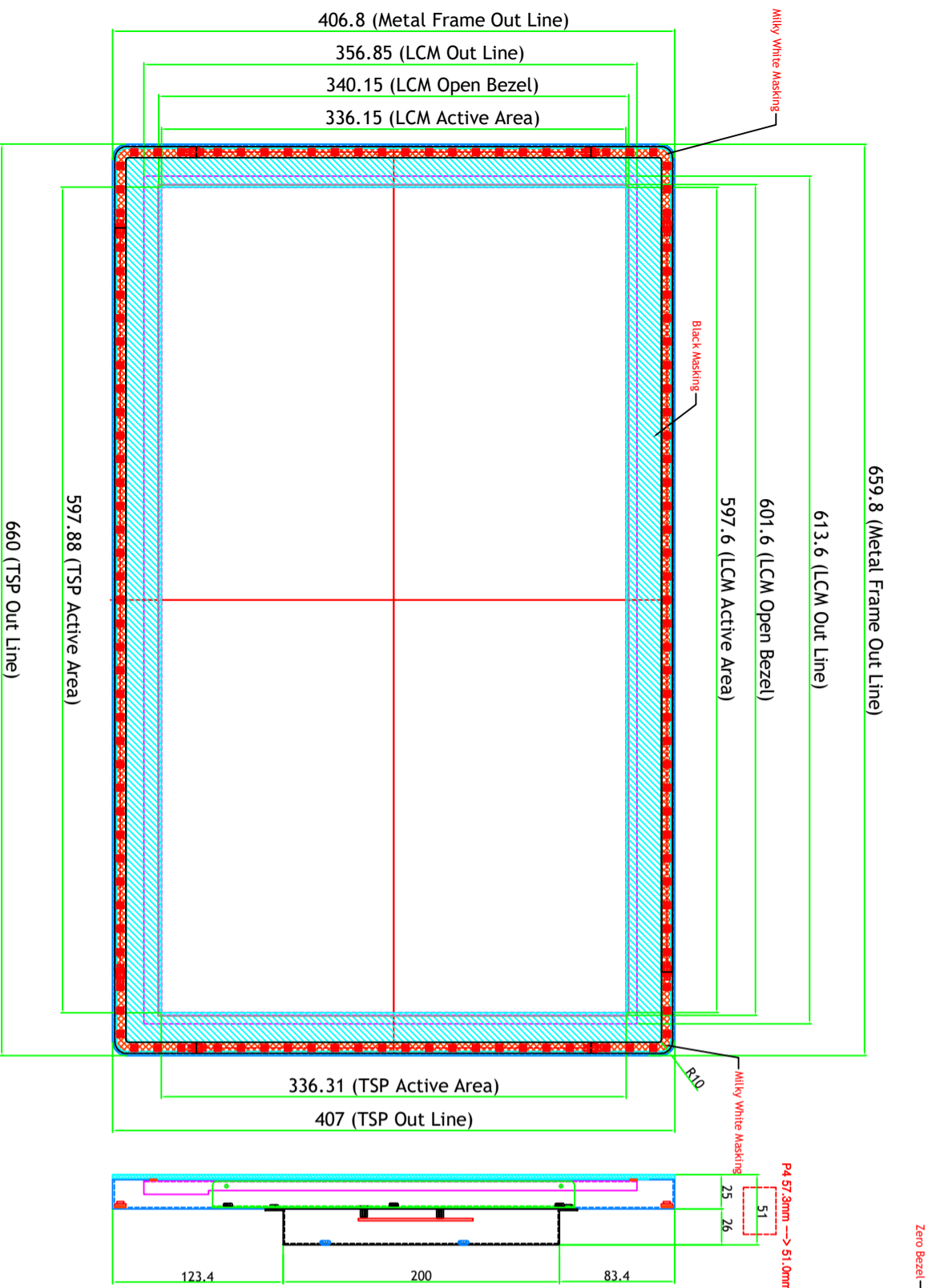

LED Lighting Control Port Pin Map (w/ IC)

#1 : VCC 5V , #2 : CTL , #3 : GND
#4 : NC, #5 : NC, #6 : NC

Molex 43020-0600

		MODEL NO	150LP2702		VIEW :		UNIT : mm
DRAWN	CHECKED	NAME	27.0" Closed Frame		Qty	1	REV. P5
H.I.Woo	H.Y.Sohn	DWG. NO	4M2703033-04		SCALE	1 / 1	DATE
		MATERIAL / FINISH	EGIT=1.2		2019.05.28		

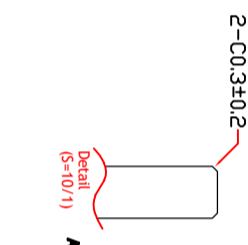

Rev	AMEND	DATE	CHECK	APPR.
P1	Proto	2017.12.08	H.I.Woo	H.Y.Sohn
P2	Changed Model Name INC-2703FHRNPC-U ---> 150LP2700	2018.01.03	H.I.Woo	H.Y.Sohn
P3	Changed Main Frame Size H : 663 --> 660mm / V : 410 --> 407mm	2018.02.05	H.I.Woo	H.Y.Sohn
P4	Changed Frame Total thickness 57.3mm --> 51.0mm	2018.05.10	H.I.Woo	H.Y.Sohn
P5	Changed I/O Port Name RGB Input ---> VGA Input	2019.05.28	H.I.Woo	H.Y.Sohn

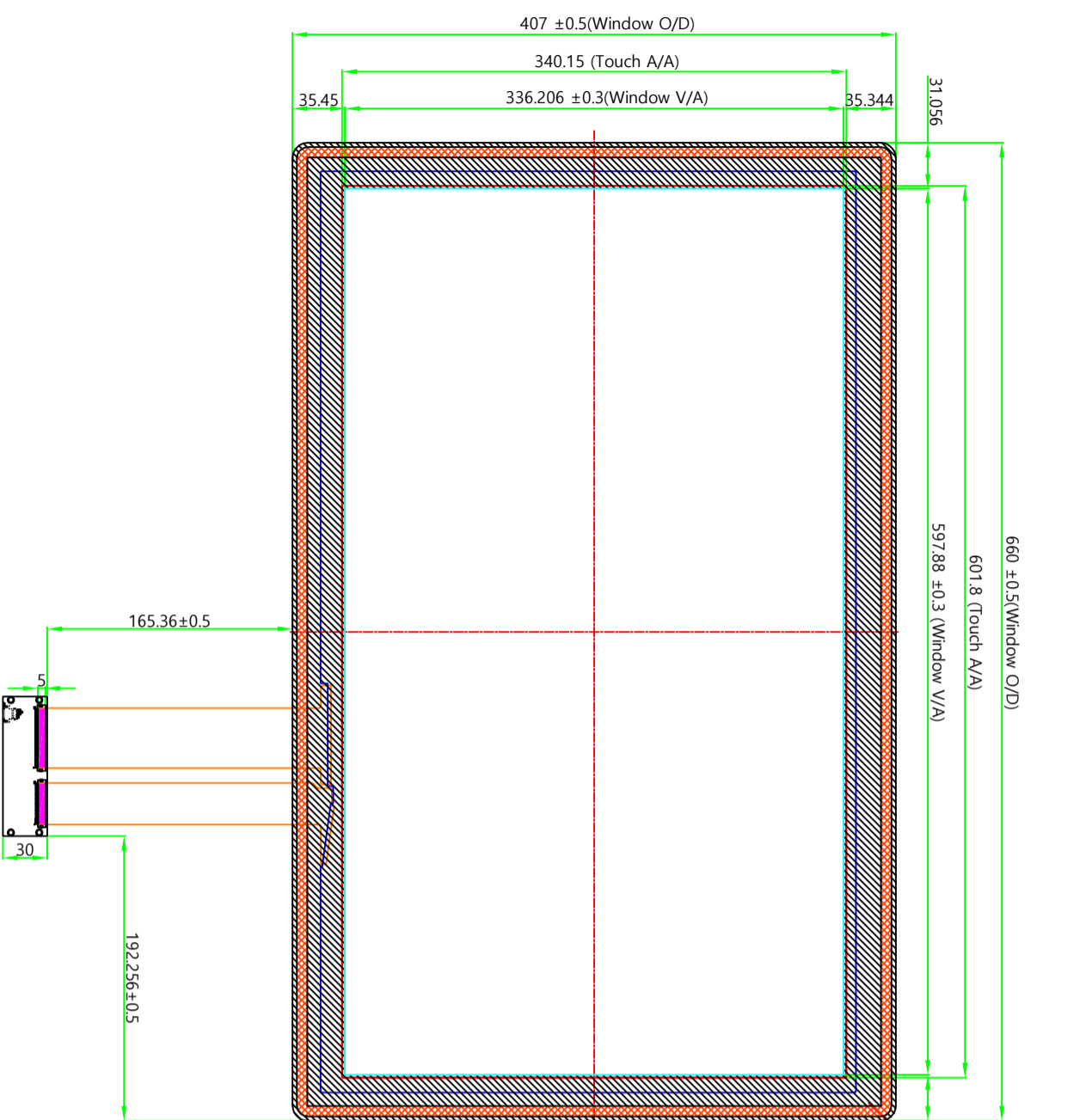

- TOP VIEW (Touch Module) -

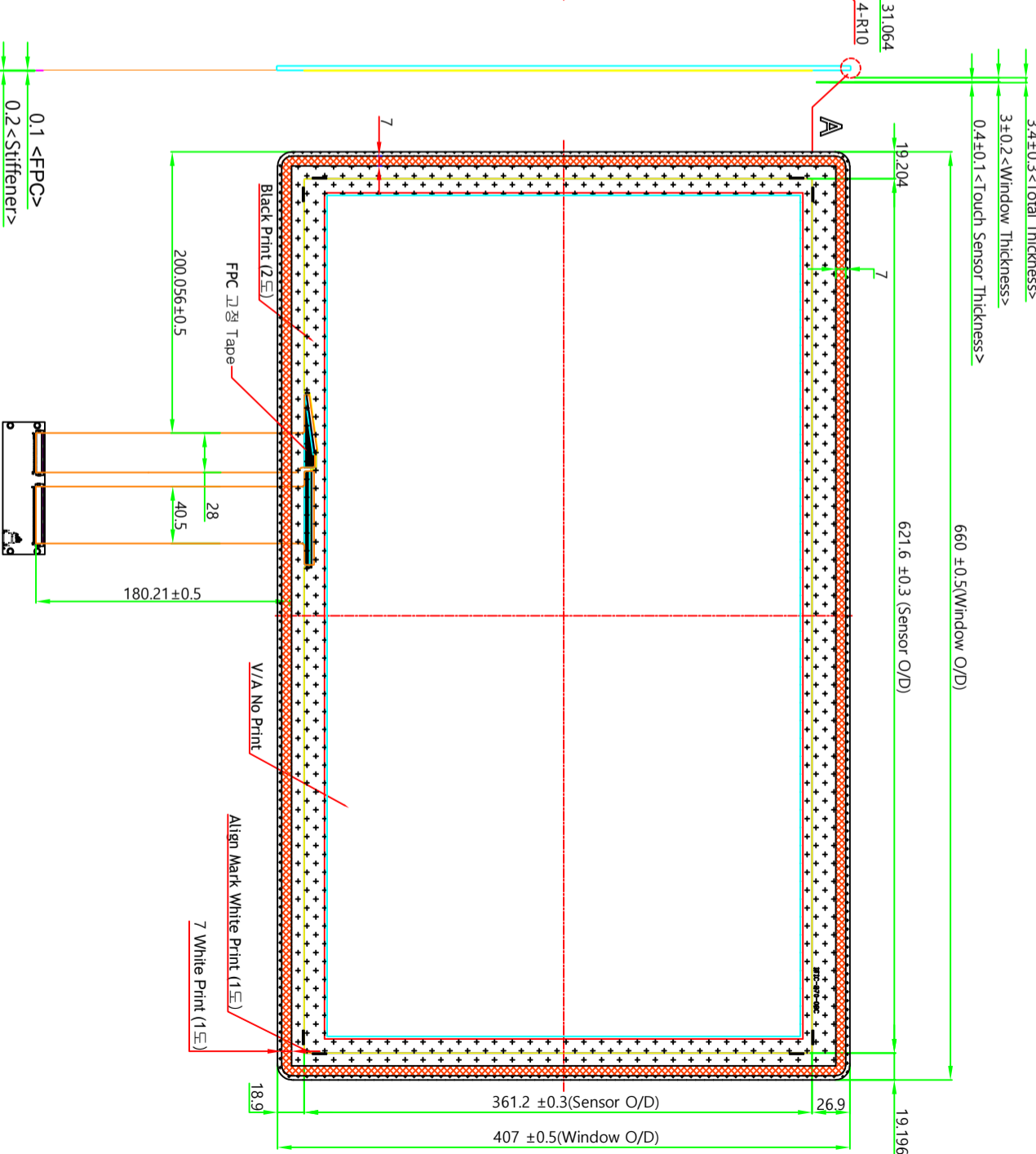

- RIGHT VIEW -

- BOTTOM VIEW -

- Black Masking : 2 time
- Milky White Masking : 2 time
- Touch Align Mark : 1 time

27.0" LED-Front Lighting Model Touch Glass Drawing

STACK UP & MATERIAL

Descriptor	Material	Thickness
Cover Window	Tempered Soda Lime Glass 3T	1000um
Top DCA	LDH, DC9102D	100um
Top Film	ITO Film	100um
Mid DCA	LDH, DC9102D	100um
Bot Film	ITO Film	100um

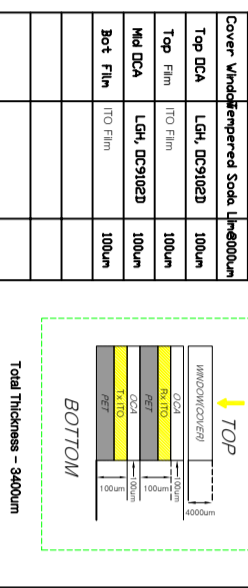

SUZOHAN??		MODEL NO	150LP2702		VIEW :	UNIT : mm	
DRAWN	CHECKED	NAME	27.0" Closed Frame		Qty	1	REV. P5
H.I.Woo	H.Y.Sohn	DWG. NO	4M2703033-04		SCALE	1 / 1	
		MATERIAL / FINISH	EGI T=1.2		DATE	2019.05.28	

NOTES

1. Type : GFF Capacitive Touch Panel
2. Cover Window : Tempered Soda Lime Glass 3T
3. Decoration Color : Black + White
4. Touch Performance: 10 Point, 8 ϕ
5. Interface : USB
6. Transmittance : 88% \pm 3% (T/O)
7. Surface Hardness : More than 6H
8. Controller : Siliconwork