

# WorldKey

Cashless Systems



High safety standards for managing  
multiple applications

[suzohapp.com](http://suzohapp.com)

# Private cashless payment system and powerful customer management tool

The WorldKey system uses the Mifare® (standard, Plus, DesFire, NFC) technology platform to ensure high safety standards and management of multiple applications. Security in transferring data is ensured by the combination of the proprietary encryption Mifare® and RFTech TDES (Triple Data Encryption Standard). Thanks to WorldKey, the operators can manage several sales or identification applications (access to multiple services also of different operators), storing them on a single RFID support (card/key/tag/sticker). The applications can be used within a single infrastructure or extended to different businesses, either visibly or hidden. WorldKey supports the most used protocols (Executive, MDB, BDV) and is ready to integrate the Ethernet, RS485, CAN BUS, ccTalk and USB interfaces.

## Features

- System including one CPU unit and a reading device connected by a “smart” coaxial cable (patent pending)
- CPU equipped with micro USB port for connecting a PC or for piloting an external device or the Universal hand-held programming device
- Reading devices equipped with: semaphore signals according to the EVA-CVS standard with 3 status LEDs (red, yellow, green) and buzzer. Infrared interface to collect audit/log data and program the readers
- Supported vending protocols: Executive master/slave, MDB master/slave and BDV master/slave
- Automatic activation of cards/keys/tags upon first insertion
- Possibility of connection with WiFi module for audit data



The reading device is available in 3 versions

- ✓ Moon: only with key/tag insertion. Supplied with two different front panels: round and oval, ideal for retrofitting
- ✓ Sky: card insertion plus key/tag
- ✓ Galaxy: with card in tap & go mode plus key/tag insertion

## Functions

- Different prices management
- Sales prices (80x3 cashless prices + 80 cash prices)
- Single cash sales or multiple cash sales
- 3 security codes management (operator, rental, machine)
- Machine No. modifiable by the user
- Maximum value management
- Differentiated key management
- Black list/white list/log file management
- Time slots management
- Bonus management
- Accounting data management
- On-field firmware updating
- Remote management via Ethernet
- USB on the go
- CAN BUS connector
- RS485 connector
- Parallel banknote reader management
- Parallel coin validator management

## Tools

UNICO configuration program

Software suite which includes programs for audit data collection and management (according to EVA-DTS standard or Windows Excel), operating parameter programming and key/card/tag management

Software for card management (code RFT-CARD-SW)

Software for audit and log management (code RFT-AUDIT-SW)

Universal hand-held programming device  
For on-field programming through micro USB cable connection

Programming Key & Clone  
Programming Key

Audit Key



## Optional accessories

- Customisable RFID keys/tags/cards/stickers by quantity
- Credit Box for transferring credits
- LCD display
- Printer
- Countertop recharging box



## Versions

- EXE/EXE also in BDV
- EXE/MDB also in BDV
- MDB/MDB
- MDB/SLAVE

Technical Schematics



**Moon**  
Reading device for keys and tags  
(Round front plate)

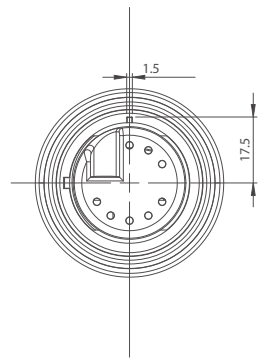
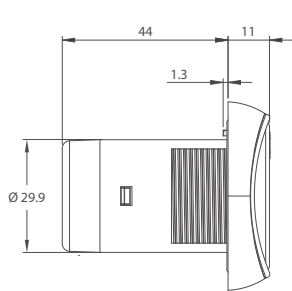
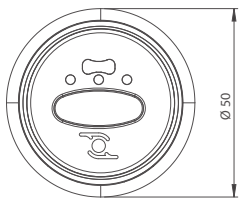

**Moon**  
Reading device for keys and tags  
(Oval front plate)

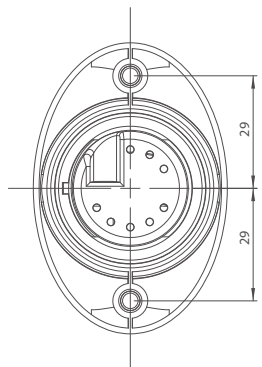
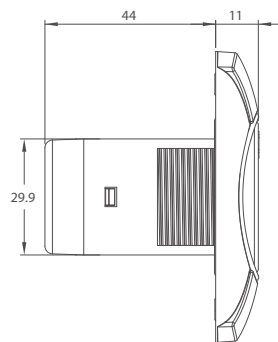
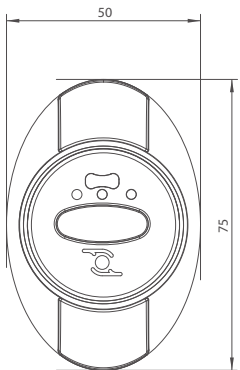

**Sky**  
Reading device for keys, tags  
and insertion cards

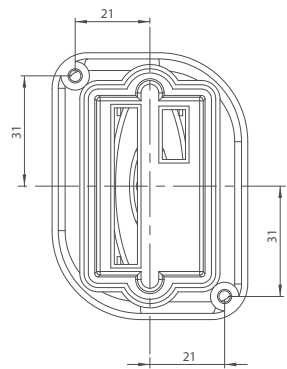
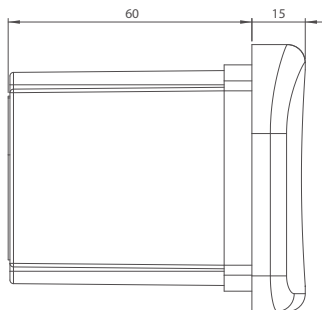
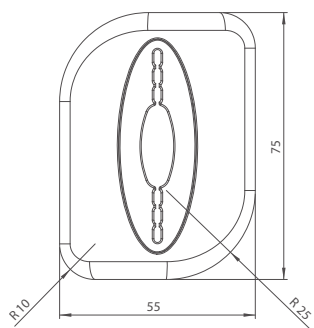

**Galaxy**  
Universal reading device  
for keys, tags and tap & go cards

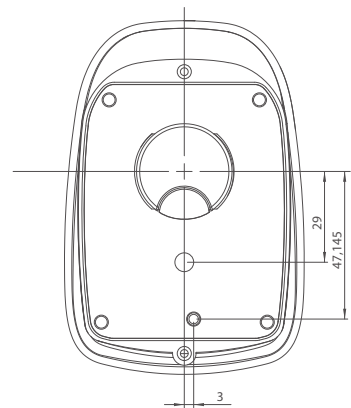
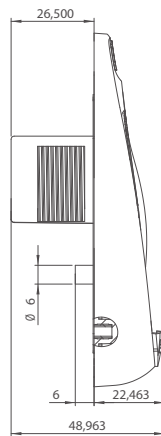
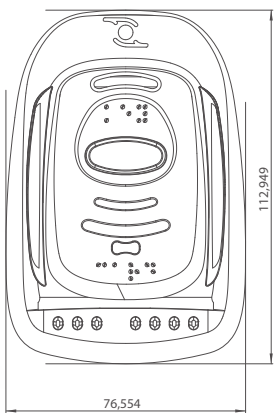

Note: Unit of measure mm



WorldKey  
CPU

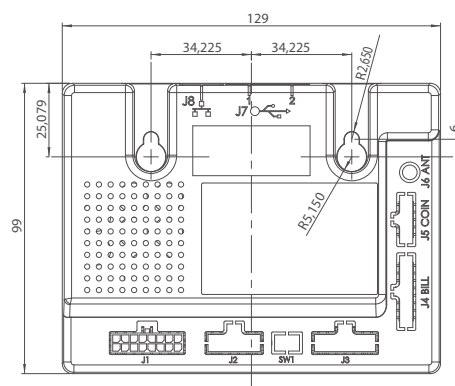

## Payment supports



Customisable **Keys** by quantity



Customisable **Cards** by quantity



Wide range of **Tags** available in different shapes and colours

## Technical Specifications - CPU

Dimensions (LxHxW)	129 x 99 x 28 mm
Weight	200 g
Power supply	15-40 Vdc - 12-27 Vac (50-60 Hz)
Power consumption	3.75W without peripherals
Operating temperature	-20 °C ÷ 50 °C
Humidity (non-condensed)	90%
Storage temperature	-20 °C ÷ 70 °C



Customisable **Stickers** by quantity



**Happy:** new customisable tags by quantity

## Technical Specifications - reading devices

	Moon (Round front plate)	Moon (Oval front plate)	Sky	Galaxy
Dimensions (LxHxW)	50 x 50 x 55 mm	50 x 75 x 55 mm	55 x 75 x 75 mm	77 x 113 x 50 mm
Weight	45 g	45 g	60 g	90 g
Operating temperature	-20 °C ÷ 50 °C	-20 °C ÷ 50 °C	-20 °C ÷ 50 °C	-20 °C ÷ 50 °C
Humidity (non-condensed)	90%	90%	90%	90%
Storage temperature	-20 °C ÷ 70 °C	-20 °C ÷ 70 °C	-20 °C ÷ 70 °C	-20 °C ÷ 70 °C

## Technical Specifications - keys/cards/tags

Technology used	ISO 14443 – MIFARE® encrypted data and energy induction transmission
Transmission frequency	13.56 MHz