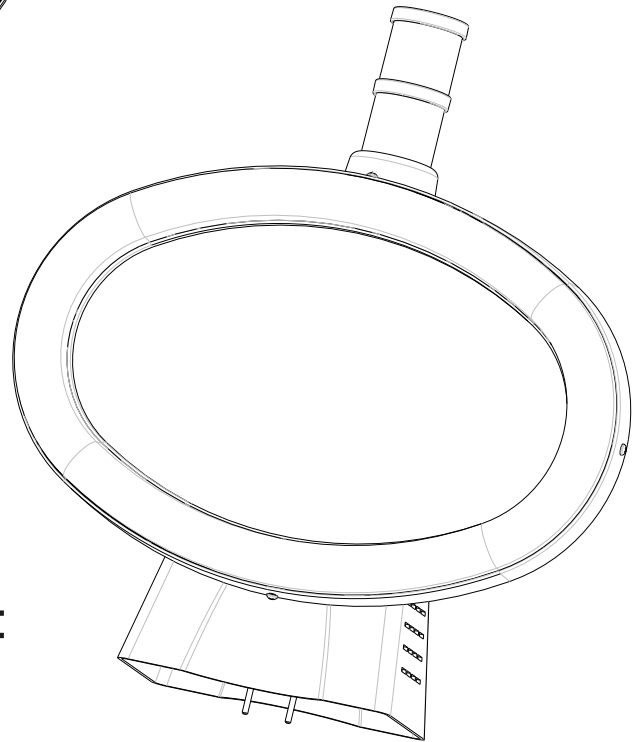
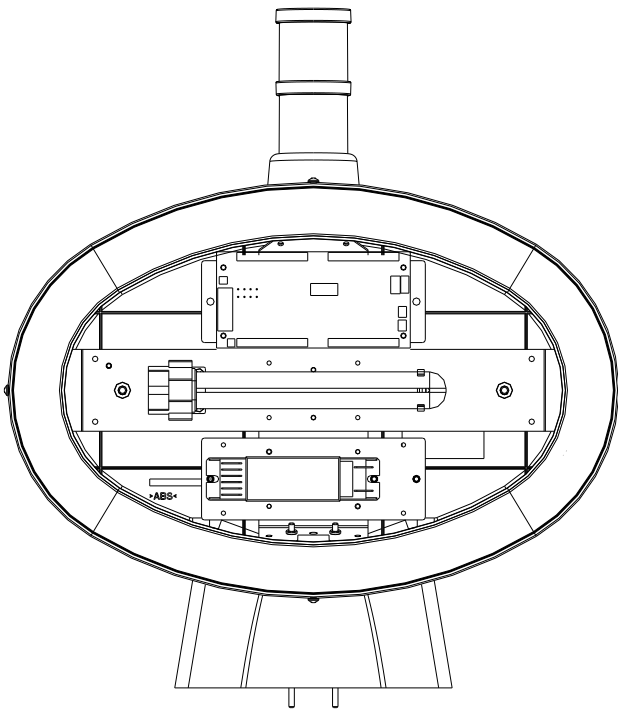


# RGB TOPPER

---

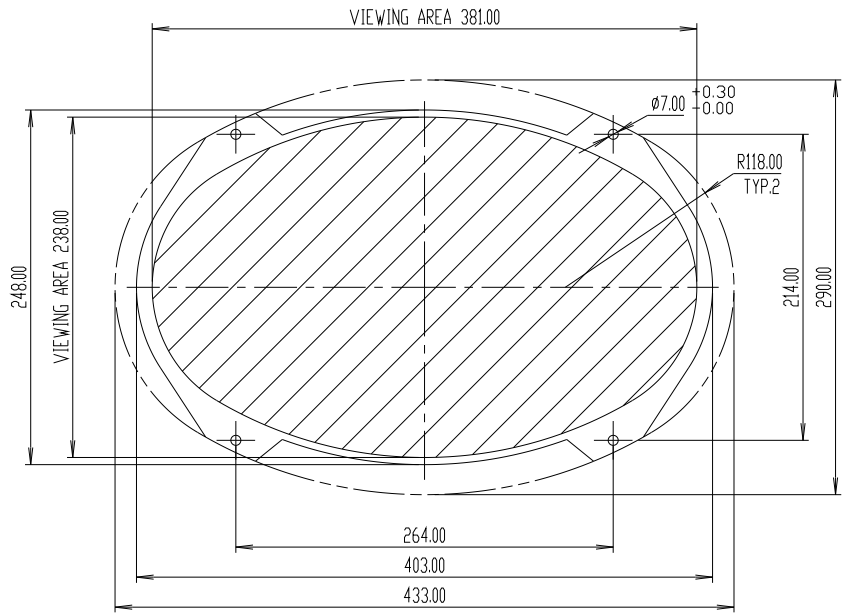


Order number for RGB topper:  
104-060X0

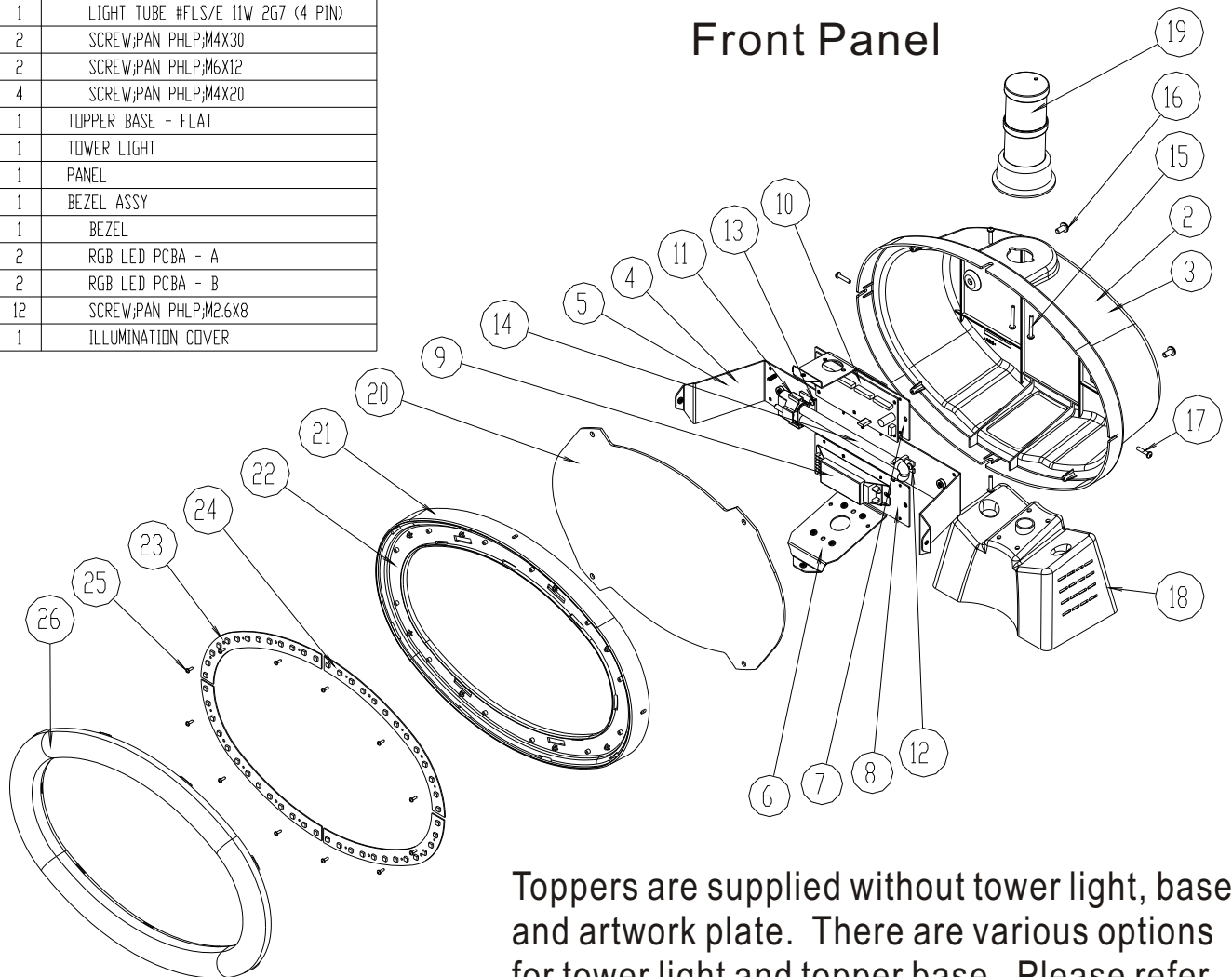
**Warning: In case of removal of the diffuser bezel do not look straight into the LED's since this may cause serious eyes injuries!**

# RGB TOPPER

BILL OF MATERIAL		
ITEM	QTY	DESCRIPTION
1	1	RGB TOPPER - MINI-ELLIPSE
2	1	HOUSING ASSY
3	1	HOUSING WITH SPRAYING
4	1	METAL BRACKET ASSY
5	1	BRACKET A
6	1	BRACKET B
7	1	BRACKET C
8	1	BRACKET D
9	1	POWER TRANSFORMER (#22-0138)
10	1	MAIN PCB ASSY
11	1	LIGHT TUBE HOLDER
12	1	LIGHT MOUNT BRACKET
13	3	SCREW;PAN PHLP;M4X8
14	1	LIGHT TUBE #FLS/E 11W 2G7 (4 PIN)
15	2	SCREW;PAN PHLP;M4X30
16	2	SCREW;PAN PHLP;M6X12
17	4	SCREW;PAN PHLP;M4X20
18	1	TOPPER BASE - FLAT
19	1	TOWER LIGHT
20	1	PANEL
21	1	BEZEL ASSY
22	1	BEZEL
23	2	RGB LED PCBA - A
24	2	RGB LED PCBA - B
25	12	SCREW;PAN PHLP;M2.6X8
26	1	ILLUMINATION COVER

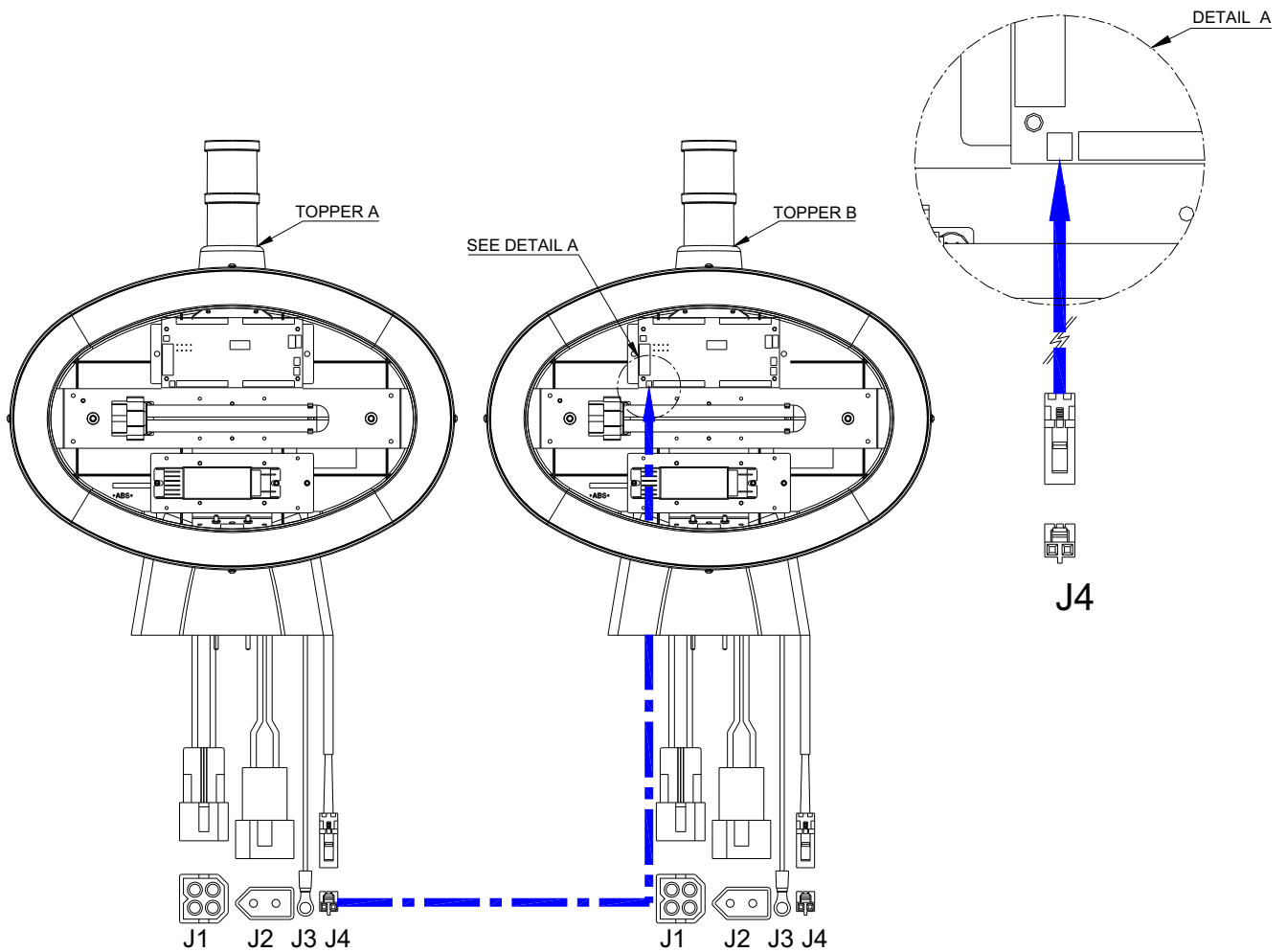


## Front Panel



Toppers are supplied without tower light, base and artwork plate. There are various options for tower light and topper base. Please refer to General Catalogue for detail.

# RGB TOPPER



## WIRE CONNECTION

NO	WIRE COLOR	DESCRIPTION	PIN	TOPPER CONNECTOR TYPE	MACHINE CONNECTOR TYPE
J1	BLACK	COMMON TOWERLIGHT	1	MOLEX MALE 03-09-2049	MOLEX FEMALE 03-09-1049 02-09-1118 (SOCKET)
	YELLOW	LAMP 2ND FROM BOTTOM	2		
	WHITE	LAMP BOTTOM	3		
	BLUE	LAMP 3TH FROM BOTTOM	4		
J2	ORANGE	POWER 12VDC	1	MOLEX MALE 03-09-2022	MOLEX FEMALE 03-09-1049 02-09-1118 (SOCKET)
	BLACK	POWER GROUND	2		
J3	TINNED STRAP	EARTH BONDING STRAP	-	-	RING TERMINAL 4mm
J4	BLACK	GROUND	1	MOLEX FEMALE 50-57-9402 #70058 (TERMINAL)	CHYAO MALE JS-1143-02P
	WHITE	TXD/RXD	2		

### IMPORTANT:

1. Shut-off power from host machine during installation.
2. Power supply to Topper: 12VDC 4.5A.
3. Number of LEDs: 52 (Ultra-bright multi-colour LED from Nichia)
4. For best performance, synchronize cable (J4) should not be longer than 10M. Extended cable should be shielded cable comply with UL 2464.

# RGB TOPPER

---

## Setting colour for RGB Topper

You may select flashing colour set out of seven pre-defined combinations as below:

A. Press COLOUR button on the main control board once - Topper will switch to next and stay on this colour set until COLOUR button is activated again.

B. Last colour setting will be stored to memory when power off.

C. The seven colour sets are defined as follow:

1. Red - Blue - White (Default setting)
2. Green - White - Red
3. White - Yellow - Red
4. Yellow - White - Blue
5. Blue - Purple - White
6. Green - Blue - Yellow
7. Green - Red - Blue

## Setting flashing pattern for RGB Topper

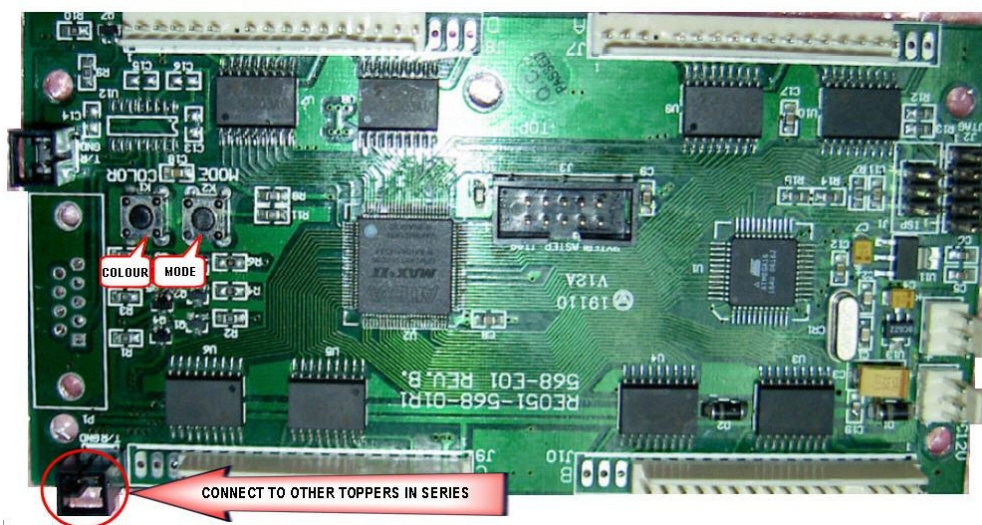
You may select flashing patterns as below:

A. Cycling through 7 pre-programmed flashing patterns (Default setting)

B. Press MODE button once - Topper will switch to next flashing pattern and stay on this pattern until MODE button is activated again.

C. Press and hold MODE button for 3 seconds - Topper will resume to default setting and cycle through the pre-programmed patterns.

D. Last flashing mode will be stored to memory when power off.



Topper Control Board

# RGB TOPPER

## Synchronize Toppers connected in series

You may synchronize colour and flashing pattern for Toppers connected in series through standard RS232C COM port as below:

A. Connect Toppers with cables as shown on page 3.

B. Conduct above settings to change colour and /or flashing pattern through any one of the toppers connected in series.

C. If Toppers are connected in series, the first powered up topper will dominate the colour and pattern for whole series until it is changed.

RGB Topper 104-06000 complies with EMC requirement and the Ballast, 22-0138, used on topper also complies with CE and UL regulations.

	
<b>THE HONG KONG STANDARDS AND TESTING CENTRE LTD.</b>	
<b>EC DECLARATION OF CONFORMITY</b>	
<b>Reference Number:</b>	EMC0704440DOC
Dynamics Chinatec Industries (HK) Ltd. 809-810 Block A, Hoi Luen Ind. Ctr, 55 Hoi Yuen Road, Kwun Tong, Kowloon, Hong Kong.	
Description:	RGB Topper
Brand Name:	N/A
Model:	104-06000
complies with the requirements of the EC Council Directive on electromagnetic compatibility 2004/108/EC	
<b>Applicable Standard(s) with amendments:</b>	
EN55015: 2006 EN61547: 1995 +A1: 2000	
General Remarks: This declaration is only valid when used in conjunction with the technical file(s) refers to HM159903. This declaration applies specifically to the sample(s) investigated in the technical report mentioned above, and not to the bulk.	
The CE marking as shown below can be affixed on the product after preparation of necessary conformity documentation, as stipulated in Articles of the Council Directive 2004/108/EC.	
<b>Manufacturer/Importer</b>  Signature	
	<b>Test Laboratory</b>  Dr. LEE Kam Chuen ElectroMagnetic Compatibility Department For and on behalf of The Hong Kong Standards and Testing Centre Ltd.
www.hkstc.org	<b>Date of Issue:</b> 2007-09-06

# RGB TOPPER

**ATC**<sup>®</sup>

**CERTIFICATE**  
of Conformity  
EC Council Directive 73/23/EEC  
as last amended by EC Directive 93/68/EEC  
Low Voltage Directive

Registration No.: ATS2005328 002

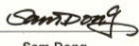
**Applicant:** Dynamics Chinatex Industries (HK) Ltd.  
809-810 Block A, Hoi Luen Ind. Ctr.55, Hoi Yuen Road, Kwun Tong  
Kowloon, Hong Kong

**Product:** DC Electronic Ballast

**Identification:** Model No. : 22-0138  
Serial No. : n.a.  
Rating : 22-0138: DC12V, 11W

**Standards:** EN 61347-1:2001  
EN 61347-2-4:2001

The certificate of conformity is based on an evaluation of a sample of the above-mentioned product. Technical report and documentation are at the applicant's disposal. This is to certify that the tested sample is in conformity with all provisions of Annex I of Council Directive 73/23/EEC, in its latest amended version, referred to as the Low Voltage Directive. This certificate does not imply assessment of the production and does not permit the use of ATC's logo. The applicant of the certificate is authorized to use this certificate in connection with the EC declaration of conformity according to Annex III of the Directive.

Certified by  
  
Sam Dong

November 14, 2005  
Date



CE      The CE Marking may only be used if all relevant and effective EC Directives are complied with.      CE

ACCURATE TECHNOLOGY CO. LTD - F1, Bldg. A, Changyuan New Material Port, Keyuan Rd. Science & Industry Park, Nanshan Dist., Shenzhen 518057, P.R. China  
Tel.: +86-755-2650 3290 Fax: +86-755-2650 3396 E-mail: webmaster@atc-lab.com

**ATC**<sup>®</sup>

**CERTIFICATE**  
of Conformity  
EC Council Directive 89/336/EEC  
as last amended by EC Directive 93/68/EEC  
Electromagnetic Compatibility

Registration No.: ATE20051871 002

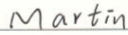
**Applicant:** Dynamics Chinatex Industries (HK) Ltd.  
809-810 Block A, Hoi Luen Ind. Ctr.55 Hoi Yuen Road, Kwun Tong,  
Kowloon, Hong Kong.

**Product:** DC Electronic Ballast


**Identification:** Model No. : 22-0138  
Serial No. : n.a.

**Standards:** EN 55015: 2000 + A1: 2001 + A2: 2002  
EN 61547:1995+2000

The certificate of conformity is based on an evaluation of a sample of the above-mentioned product. Technical report and documentation are at the applicant's disposal. This is to certify that the tested sample is in conformity with all provisions of Annex III of Council Directive 89/336/EEC, in its latest amended version, referred to EMC Directive. This certificate does not imply assessment of the production and does not permit the use of ATC's logo. The applicant of the certificate is authorized to use this certificate in connection with the EC declaration of conformity according to Article 10.1 of the Directive.

Certified by  
  
Martin Lü

Nov. 7, 2005  
Date



CE      The CE Marking may only be used if all relevant and effective EC Directives are complied with.      CE

ACCURATE TECHNOLOGY CO. LTD - F1, Bldg. A, Changyuan New Material Port, Keyuan Rd. Science & Industry Park, Nanshan Dist., Shenzhen 518057, P.R. China  
Tel.: +86-755-2650 3290 Fax: +86-755-2650 3396 E-mail: webmaster@atc-lab.com

 **ONLINE CERTIFICATIONS DIRECTORY**

FKVS2.E309359  
Fluorescent Ballasts - Component

[Page Bottom](#)

---

Fluorescent Ballasts - Component

[See General Information for Fluorescent Ballasts - Component](#)

**SUZO/HAPP** E309359  
106 GARISCH  
ELK GROVE VILLAGE, IL 60007 USA

**Electronic type, Class P, Models 22-0138, 22-0139.**

Marking: Company name and catalog designation. [Last Updated](#) on 2006-11-10

 **ONLINE CERTIFICATIONS DIRECTORY**

FKVS8.E309359  
Fluorescent Ballasts Certified for Canada - Component

[Page Bottom](#)

---

Fluorescent Ballasts Certified for Canada - Component

[See General Information for Fluorescent Ballasts Certified for Canada - Component](#)

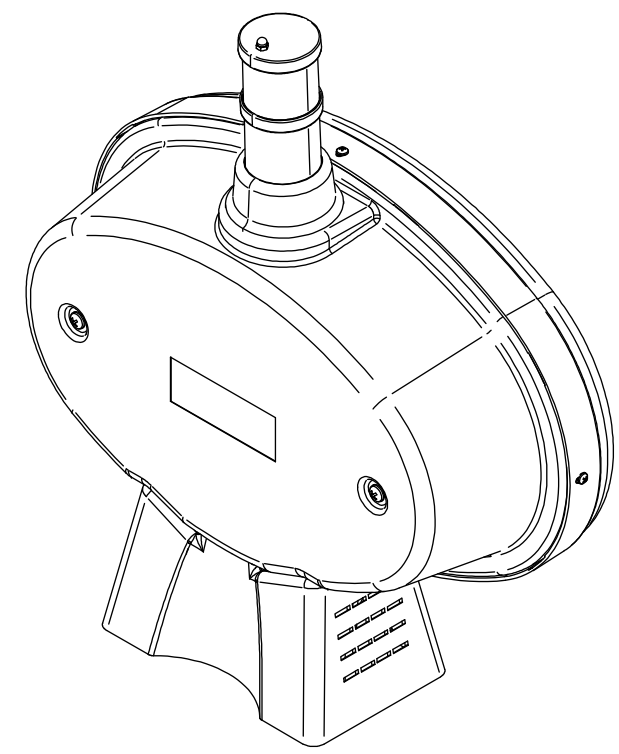
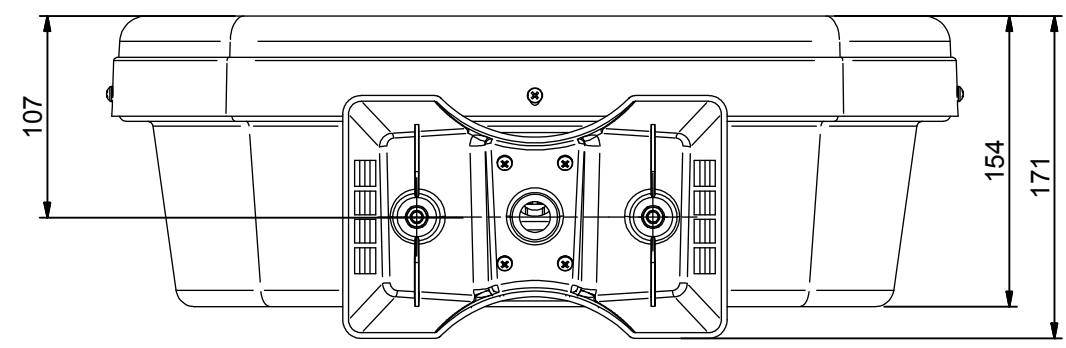
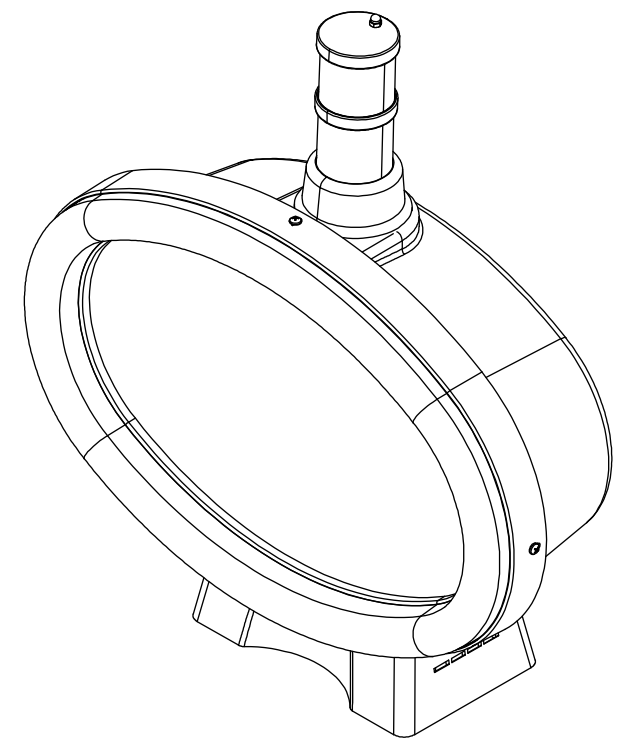
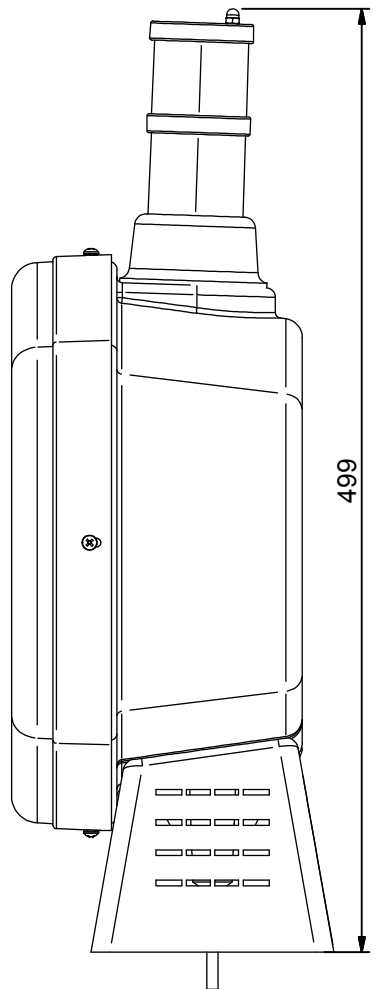
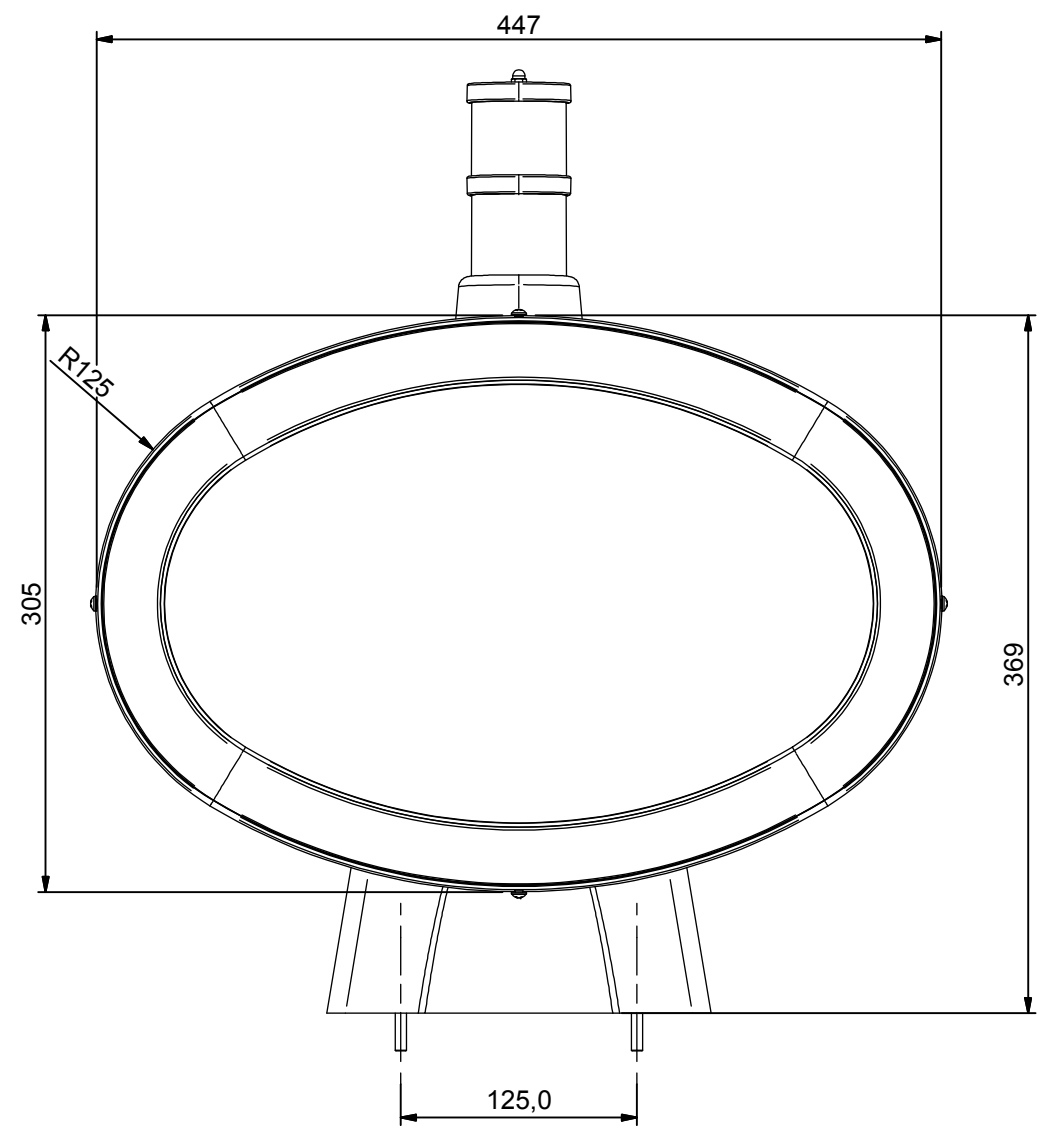
**SUZO/HAPP** E309359  
106 GARISCH  
ELK GROVE VILLAGE, IL 60007 USA

**Electronic type, Class P, Models 22-0138, 22-0139.**

Marking: Company name and catalog designation and Recognized Component Mark for Canada, . [Last Updated](#) on 2006-11-10

**Note:** The specifications and information contained here are for quick reference only and are subject to change without notice. For detail product specification, please refer to formal product documentation.

REVISION HISTORY			
REV	DESCRIPTION	DATE	APPROVED
00	INITIAL RELEASE	24-9-2008	Maarten



Suzo International (NL) BV  
 Antonie van Leeuwenhoekstraat 9  
 3261 LT Oud Beijerland  
 Tel. +31 (0)186-643333  
 Fax. +31 (0)186-643355  
 E-mail info@suzo.com

RoHS Compliant 2002/95/EC

Description:	Date:	Partnumber:	Revision:	Size:
ELLIPSE MINI TOPPER RGB	24-9-2008	104-060X0_dim	00	A3

## Topper Base options



**Figure 9: Base Topper 15 degrees slanting (104-0010-2)**



**Figure 10: Base Topper BCT Rio (104-0014-2)**



**Figure 11: Base Topper R260 curved (104-0015-1)**



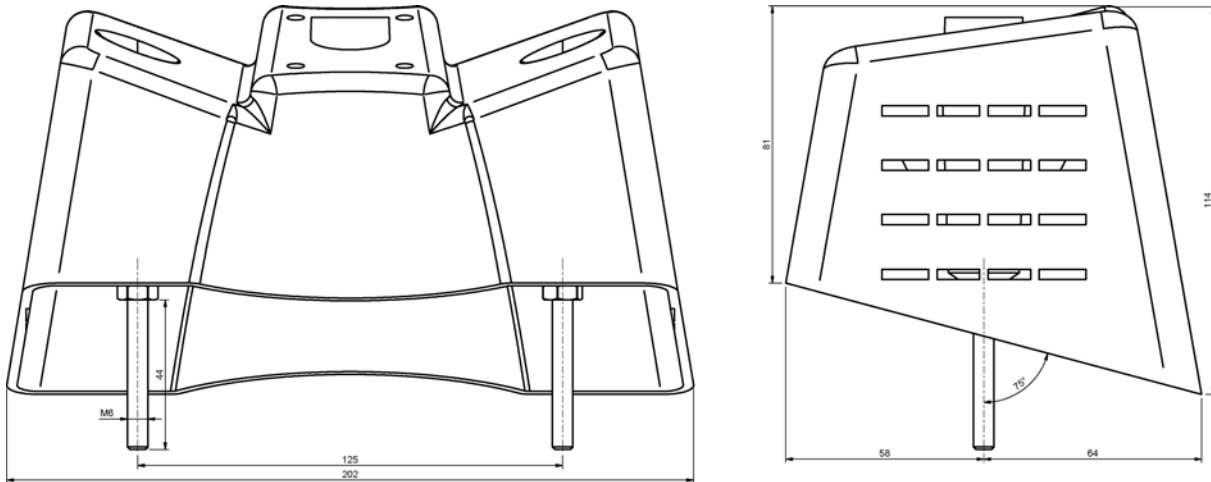
**Figure 12: Base Topper flat mounting (104-0020-1)**

---

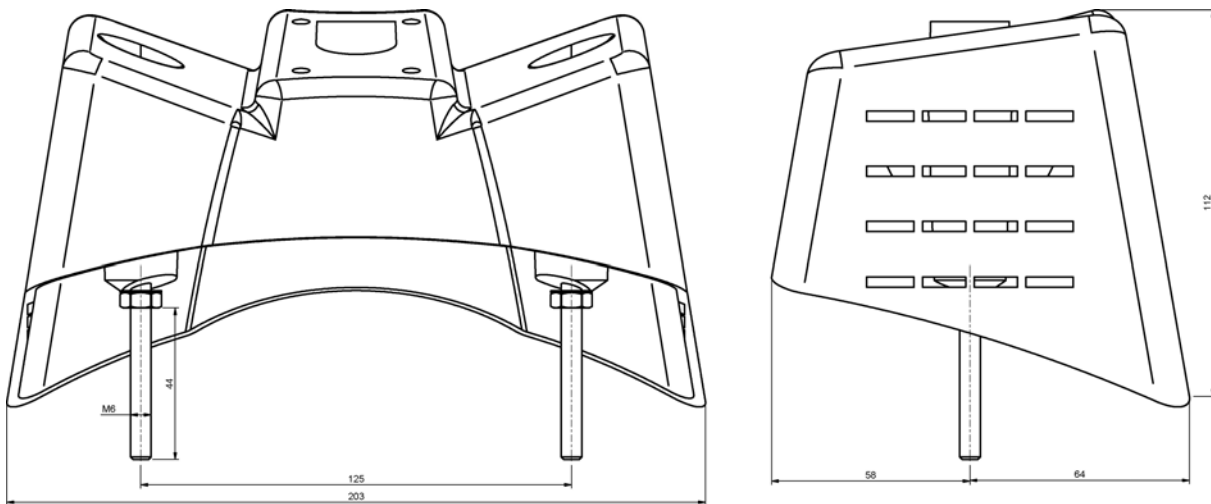


---

## Topper Base dimensions

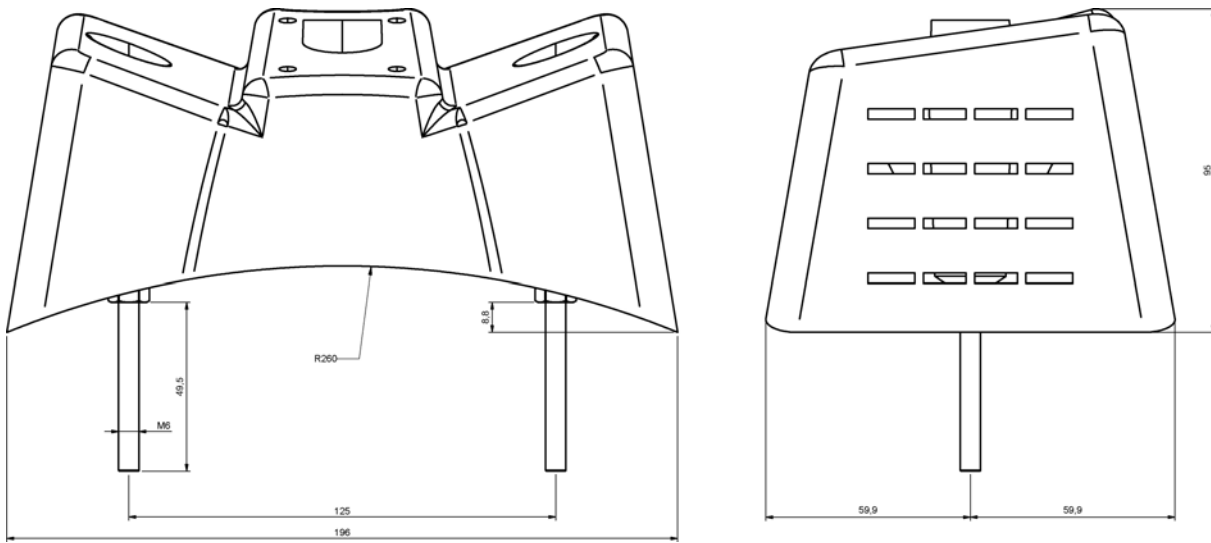


**Figure 13: Base Topper 15 Degrees slanting (104-0010-2)**

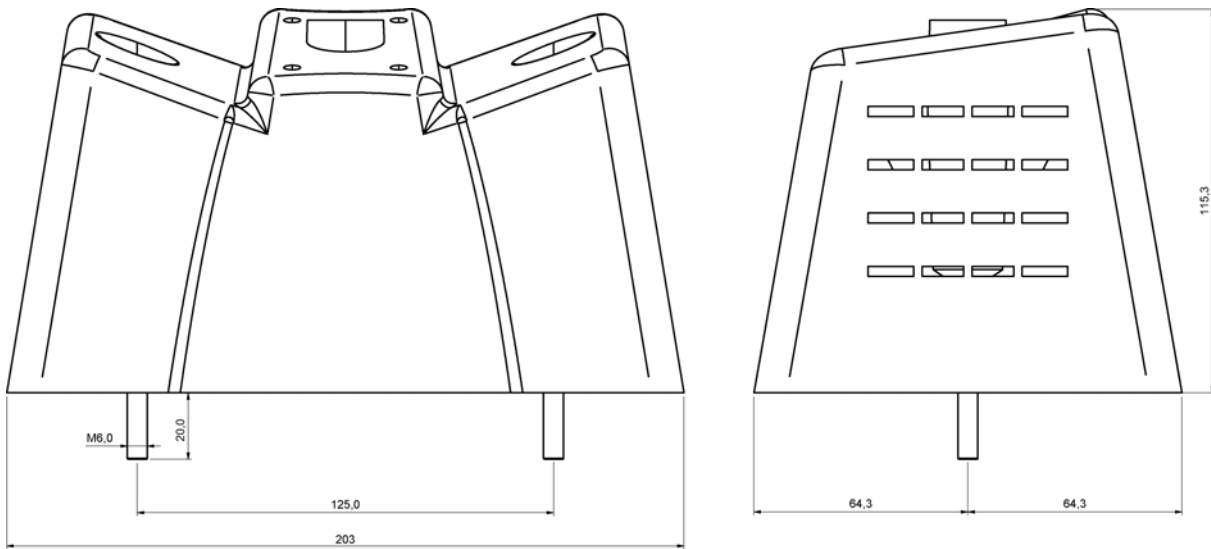


**Figure 14: Base Topper R260 curved (104-0014-2)**

---



**Figure 15: Base Topper R260 curved (104-0015-1)**



**Figure 16: Base Topper flat mounting (104-0020-1)**