

# FILLING THE COIN CASSETTE

- 1 Remove cassette by pulling cassette latch followed by an up and out motion. The cassette comes straight out (Fig. 2, A/B).
  - 2 Fill manually with the necessary coins.
- !** Do not refill the tubes above the maximum filling height (see markings on the rear of the coin cassette). Otherwise coins could fall into the coin changer when reinstalling the coin cassette thus damaging the device or affecting proper operation.
- 3 Reinsert cassette straight in and down, until it clicks in position (Fig. 2, B/C). The currenza c<sup>2</sup> is ready to operate. However, performing a test vend is recommended.

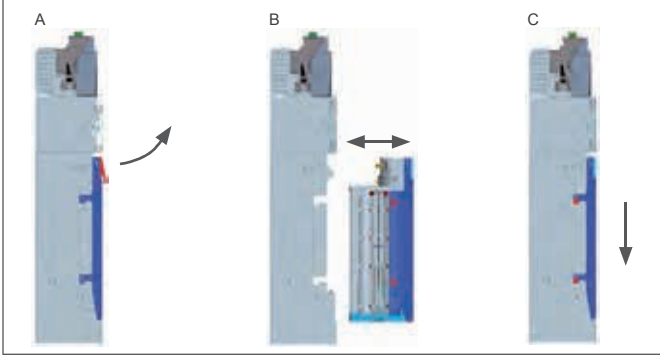

Fig. 2: Removing and reinstalling coin cassette

**i** If the change tubes are completely emptied before refilling the cassette, you should set the coin changer so that the tube counters will be reset when the cassette is removed:  
 [Menu Icon] > E = Setting > Operating modes > Tube counter correction to zero).

# SUZOHAPP

1. Fold the sheet with this side facing outwards

- 3 Hang coin changer on the three mounting points and fasten mounting screws (Fig. 1b).
  - 4 Reinsert coin validator, until it clicks in position (Fig. 1a, B/C). Make sure there is a 1/8 inch minimum gap between the return lever and its actuator.
  - 5 Connect the coin changer harness to the machine or bill validator Y-harness.
  - 6 When using a recycler also connect the 4-pin molex connector harness to the recycler Y-harness.
  - 7 Turn power ON.
- !** Ensure that the coin validator is properly connected with the coin changer by the ribbon cable.

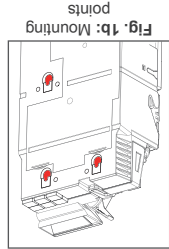
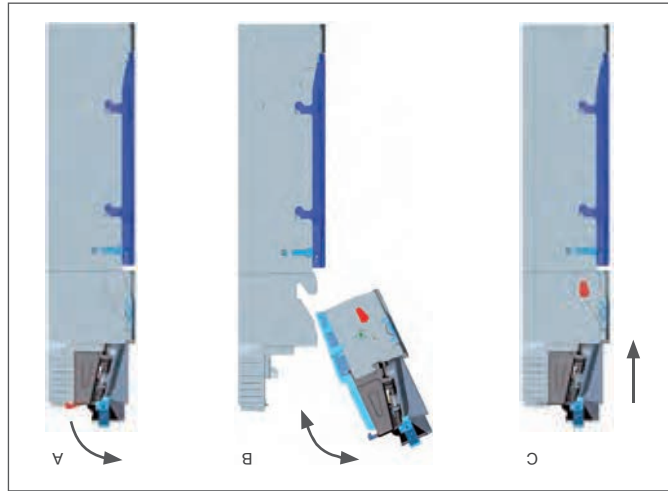

Fig. 1a: Removing and reinstalling coin validator



- 1 Turn machine's power OFF.
- 2 Unlatch coin validator using blue latch next to coin return lever and remove coin validator from main chassis (Fig. 1a, A/B).

# INSTALLATION

# currenza c<sup>2</sup> blue QUICK START-UP

## UNIT OVERVIEW

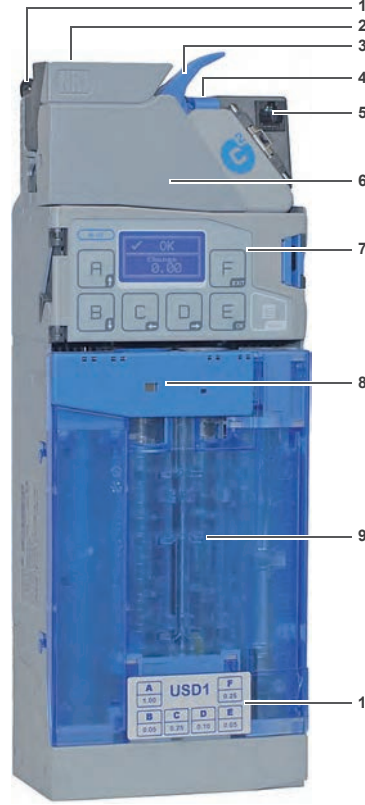

- [Menu Icon] - Enter c<sup>2</sup> configuration and service menu
- [Menu Icon] - Return to operating mode
- [A] - Dispense coin from tube A
- [A] - Select main menu item "Audit"
- [A] - Scroll up sub menu items
- [A] - Set parameters to a higher value
- [B] - Dispense coin from tube B
- [B] - Select main menu item "Inventory"
- [B] - Scroll down sub menu items
- [B] - Set parameters to a lower value
- [C] - Dispense coin from tube C
- [C] - Select main menu item "Service"
- [C] - Select digit to be set
- [D] - Dispense coin from tube D
- [D] - Show diagnostics details
- [D] - Select main menu item "Diagnostic"
- [D] - Select digit to be set
- [E] - Dispense coin from tube E
- [E] - Select main menu item "Settings"
- [E] - Access sub-menu/confirm setting
- [F] - Dispense coin from tube F
- [F] - Select main menu item "Filling"
- [F] - Go back (to main menu)

- 1 MDB machine connecting cable (not illustrated)
- 2 Coin insert funnel
- 3 Coin return lever
- 4 Latch - Removing coin validator
- 5 Interface - HENRI service module
- 6 Coin validator
- 7 User interface
- 8 Latch - Removing coin cassette
- 9 Coin cassette
- 10 Payout combination

**!** Only use this product with the intended use. The manufacturer is not liable for any damage or loss resulting from improper use.

**!** Remove coins before transporting the unit, use the original package, if possible.

**!** Do not hold or carry the unit from its harness.

**!** The unit needs to be installed by qualified personnel.

**!** Turn power OFF before the installation and routine maintenance.

**!** Make sure the coin changer bracket is properly grounded.

**!** Do not disconnect the harness with the power ON.

**!** Do not alter the construction of the unit to a greater extent than the modifications described in these instructions.

**!** Avoid spilling water or other liquids on the unit.

**!** Dispose off properly.

**!** We reserve the right to make technical modifications to the device which are not covered by these instructions!

## Protecting yourself and the equipment

The currenza c<sup>2</sup> MDB coin changer was designed to operate in vending machines with MDB interface.

This coin changer has been manufactured with state of the art technology and observing all safety regulations, however, this unit could be a source of hazard.

## Intended use

Please, read this short reference guide and most importantly these safety instructions but also the other c<sup>2</sup> short reference guides and manuals available.

# SAFETY

## LIMITING THE TUBE COIN NUMBER

The currenza c<sup>2</sup> can be configured so that each change tube of the coin cassette accepts no more than a specific number of coins. When this number is reached, all further coins for this tube are then directed into the cash-box temporarily. Only when coins have been paid out of this tube, coins are again sorted into the tube.

**i** If this function is not used, the full sensor of the tubes determines from when the coins will be sorted into the cash-box and no longer into the tubes.

**Quick approach:** > E = Setting > Coin settings > Filling level limitation

Press key ...	How often?	Effect
1	1 x	You enter the main configuration menu
2	1 x	You enter the setting menu
3	until <i>Coin settings</i>	You select coin settings submenu
4	1 x	You enter the coin settings
5	until <i>Filling level limitation</i>	You select filling limitation submenu
6	1 x	You enter the submenu
7	until required tube	For this tube a filling limitation is to be set
8	1 x	Now you can set the filling limitation
9	until required digit	You want to set this digit
10	until required value	This value is to be set
11	Repeat steps 9 and 10 to set the other two digits of the filling level limitation	
12	1 x	You lock your setting in memory.
13	If necessary, repeat steps 7 to 12 to set filling level limitations of the other tubes	
14	1 x/2 x	You return to main menu/operation mode

## CLEANING

Only the changer's coin path, flight deck and sorter cover must be cleaned from time to time. Over and above there is no further maintenance work to do.

- Cleaning interval: as required
- Cleaning aids: compressed air/small brush slightly wet cloth luke warm water



**Do not spray cleaning solutions.**  
Under no circumstances may the coin changer be immersed or the cloth be so wet that fluid runs into the device. Other the PCB will be damaged. Do not use any solvents or scouring agents which attack the plastic of the device.  
Turn power OFF before you clean the coin changer.

To clean the coin path, flight deck and sorter cover:

- 1 Turn power OFF.
- 2 Unlatch sorter cover (blue latch on the right of the display) and swing it open (Fig. 3, A&B).
- 3 Open flight deck at the insert funnel and hold it open (Fig. 3, C).
- 4 Remove any debris. Dust off any accumulation with a small brush or compressed air.
- 5 Clean the complete coin path, front and back, with a slightly wet cloth.
- 6 Allow to dry.
- 7 Close flight deck and latch sorter cover.
- 8 Turn power ON.

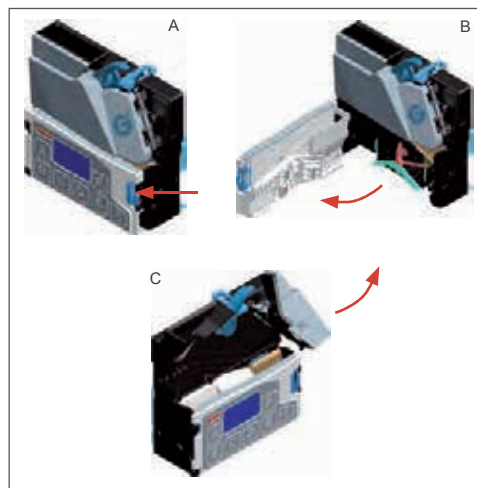

Fig. 3: Opening coin validator's sorter cover and flight deck

## CHANGING COIN CASSETTE CONFIGURATION

The currenza c<sup>2</sup> comes with pre-programmed coin cassette configurations. The specific configuration is indicated on a label on the front of the cassette, i.e.: USD1, USD8, etc.

Please follow the simple procedure of the right-hand table to change the payout configuration.

**Quick approach:** > E = Setting > Coin settings > Coin sorting > Select coin cassette

Press key ...	How often?	Effect
1	1 x	You enter the main configuration and service menu
2	1 x	You enter the setting menu
3	until <i>Coin settings</i>	You select coin settings submenu
4	1 x	You enter the coin settings
5	until <i>Coin sorting</i>	You select coin sorting submenu
6	1 x	You enter the coin sorting submenu. "Select coin cassette" is highlighted
7	1 x	You enter the first tube combination 01
8	until new payout configuration (01–13)	You select desired payout configuration
9	1 x	You lock you selection in memory. c <sup>2</sup> confirms with info screen "OK"
10	1 x/2 x	You return to main menu/operation mode

## DIAGNOSTICS & TROUBLESHOOTING

**Quick approach:** > D = Diagnostic

The currenza c<sup>2</sup> provides you with detailed information for diagnostics and troubleshooting. If a section of the unit is malfunctioning, the built-in display gives you a warning message pointing to the problem.

In addition, the Diagnostics menu provides specific details:

Press key ...	How often?	Effect
1	1 x	You enter the main configuration and service menu
2	1 x	You enter the diagnostics menu
3	until relevant unit section	You select relevant module
4	1 x	You enter the diagnostics screen for the changer module selected
5	Please check status for this and all other modules comprising the unit.	
6	1 x/2 x	You return to main menu/operation mode